



sistema de batente de 56mm com corte térmico

56mm opening system with thermal break

système d'ouvrant de 56mm à rupture de pont thermique





Características do Sistema

System features

Caractéristiques du système



Reflexo do aperfeiçoamento aos sistemas de batente surge o sistema IT com uma secção intermédia de 56mm. Baseado no pressuposto de melhoramento das prestações térmicas e acústicas mas mantendo o factor competitivo, este sistema foi desenvolvido com o objectivo de oferecer uma excelente solução para obras de gama corrente, garantindo uma excelente relação qualidade/preço."

Reflection of improving to the jamb systems arises the IT system with an intermediate section of 56mm. Based on the assumption of improved thermal and acoustic performance while maintaining the competitive factor, this system was developed with the aim to offer an excellent solution to works of current range, ensuring excellent quality / price ratio.

Reflet de l'amélioration des systèmes battante, surgit le système IT avec une section intermédiaire de 56mm. Basé sur l'hypothèse d'amélioration de la performance thermique et acoustique tout en conservant le facteur de compétitivité, ce système a été développé dans le but d'offrir une excellente solution pour les travaux de la gamme actuelle, assurant un excellent rapport qualité / prix.

Apresentação:	Reta Oval
Presentation	Straight Oval
Présentation	Droite Ovale
Dimensões:	Aro Fixo: 56mm
Dimensions	Fixed frame
Dimension	Cadre dormant
	Aro Móvel: 63mm
	Mobile frame
	Cadre ouvrant
Bites:	Retos ou Redondos
Glazing beads	Straight or Round
Parcloses	Droite ou Arrondie
Enchimento:	De 4 a 43mm
Filling	From 4 to 43mm
Remplissage	De 4 à 43mm
Canal:	Câmara Europeia Canal 16
Channel	European chamber Channel 16
Chenal	Chambre européenne Chenal 16
Cortes:	45° 90°
Cuts	
Coupes	
Vedação:	Junta em EPDM
Insulation	EPDM joints
Étanchéité	Joint en EPDM
Unições:	Exterior: De várias dimensões
Joint	Interior: Com esquadros de bloqueio e uniões de travessa
Union	Outer: Several dimensions Inner: blocking brackets and transoms unions
	Extérieur: Diverses dimensions Intérieur: Équerres de verrouillage et unions des traverses
Poliamida:	Aro fixo: 24mm Aro móvel: 20mm
Polyamide	Fixed frame Mobile frame
Poliamide	Cadre dormant Cadre ouvrant
Peso máximo:	Janela batente (int./ext. 1 2 folhas) - 150 Kg/folha leaf vantail
Maximum weight	Casement (in/out 1 2 leaves) Fenêtre à la française (int./ext. 1 2 vantaux)
Poids maximale	Porta batente (int./ext. 1 2 folhas) - 180 Kg/folha leaf vantail
	French door (in/out 1 2 leaves) Porte (int./ext. 1 2 vantaux)
	Oscilo-batente - 150 Kg/folha leaf vantail
	Tilt and turn Oscillo-Battant
	Oscilo-paralela - 160 Kg/folha leaf vantail
	Tilt and slide Oscillo-coulissant
	Projetante - 120 Kg/folha leaf vantail
	Awning à l'italienne
	Basculante - 70 Kg/folha leaf vantail
	Hopper À soufflet
	Harmónio - 80 Kg/folha leaf vantail
	Fold Repliable
Acabamentos:	Lacados Anodizados Bicolores
Finishes	Powder coating Anodizing Bicolour
Finitions	Laqué Anodisé Bicolore

ALUMINIUM ASSOCIATION
EUROPEAN ANODISERS ASSOCIATION
Qualanod
Licença nº. 1406 - Metalferr
Licença nº. 1411 - Alfa Sul

QUALICONT
Licença nº. 809

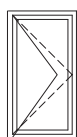

Batente int|ext 1|2 folhas
casement in|out 1|2 leaves
française int|ext 1|2 vantaux

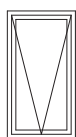

Projetante
awning
à l'italienne

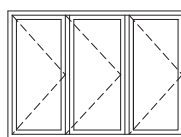

Harmónio 3|4|5|6|7 folhas
fold 3|4|5|6|7 leaves
repliable 3|4|5|6|7 vantaux



Oscilo-batente 1|2 folhas
tilt and turn 1|2 leaves
oscillo-battant 1|2 vantaux



Basculante
hopper
à soufflet

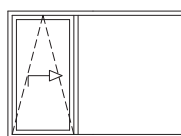

Oscilo-paralela
tilt and slide
oscillo-coulissant



Porta | Door | Porte
Batente int|ext 1|2 folhas
door in|out 1|2 leaves
française int|ext 1|2 vantaux

Desempenho do sistema

System performance

Performance du système

Marcação CE - Resultados previstos

CE Marking - Predicted results

Marquage CE - Résultats prévu

NP EN 14351-1

Janela 2 folhas com 1.60x1.40m

Vidro : 8 + 16 + 8

2 leaves window 1.60 x 1.40m

Glass: 8 + 16 + 8

Fenêtre 2 vantaux 1.60m x 1.40m

Verre: 8 + 16 + 8

Permeabilidade ao AR

AIR Permeability

Perméabilité à l'AIR

4

Estanquidade à ÁGUA

WATER Tightness

Étanchéité à l'EAU

E900

Resistência ao VENTO

WIND Resistance

Résistance au VENT

C5

Coef. Transm. TÉRMICA

THERMAL Transmittance

Coef. de Transmission THERMIQUE

 $U_w = 1,74 \text{ W/m}^2 \text{ K}$ $U_g = 1,1 \text{ W/m}^2 \text{ K}$ (Janela 2 folhas com 1,60x1,40m) $U_g = 1,1 \text{ W/m}^2 \text{ K}$ (2 leaves window with 1,60x1,40m) $U_g = 1,1 \text{ W/m}^2 \text{ K}$ (Fenêtre de 2 vantaux avec 1,60x1,40m)

Isolamento ACÚSTICO

ACOUSTIC Insulation

Isolation ACOUSTIQUE

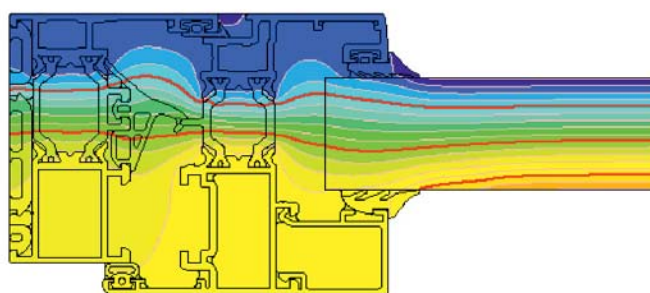
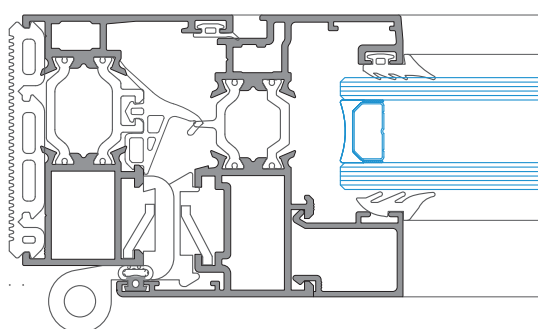
Rw janela(dB)= 36dBRw (IGU) = 36dB, área $\leq 2,70 \text{ m}^2$ Rw (IGU) = 36dB, aire $\leq 2,70 \text{ m}^2$ Rw (IGU)=36dB, aire $\leq 2,70 \text{ m}^2$ 



5

Listagem de perfis

Profiles list
Liste des profils

25

Acessórios

Accessories
Accessoires

49

Pormenores de montagem

Assembly details
Détails d'assemblage



Listagem de perfis

Profiles list

Liste des profils

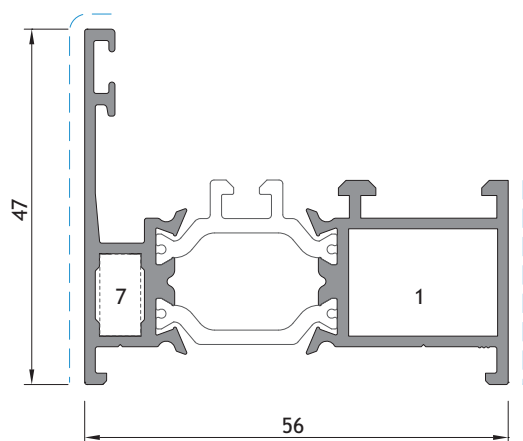

IT 01

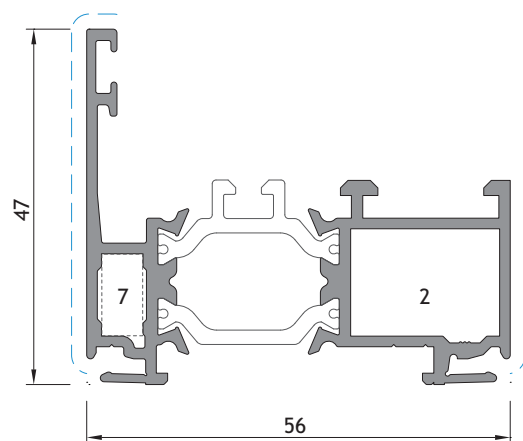

IT 51

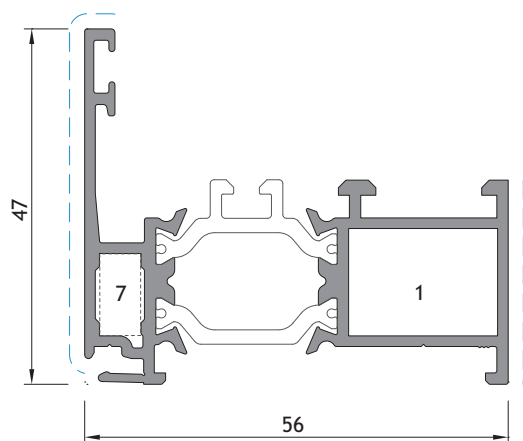

IT 31

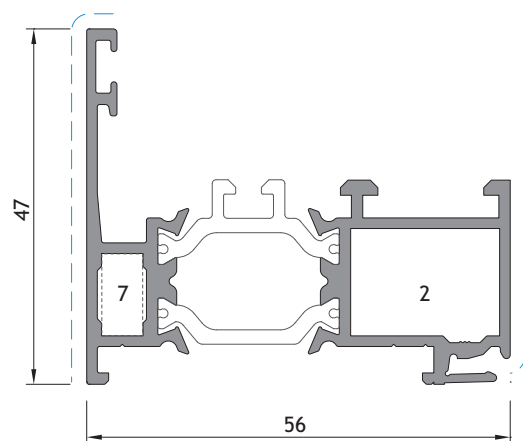

IT 41

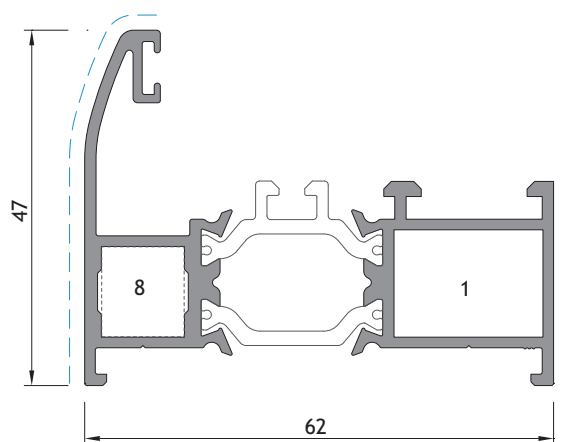

IT 38

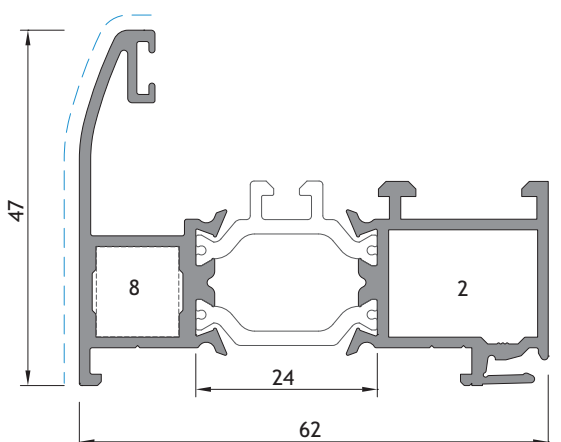

IT 28



1 - ESQUADRO IT/ST Nº 1
6 - ESQUADRO IT/ST Nº 6
10 - ESQUADRO 18-1130-C
14 - ESQUADRO 1108
18 - UNIÃO T. SA 2001G

2 - ESQUADRO IT/ST Nº 2
7 - ESQ. 18-0512-C (ou CANTO CR 0018)
11 - ESQUADRO AT ESPECIAL GRANDE
15 - ESQUADRO 26-2537-140
19 - UNIÃO T. SA 2001XP

3 - ESQUADRO IT/ST Nº 3
4 - ESQUADRO IT/ST Nº 4
8 - ESQUADRO 18-1112-C
12 - ESQ. AT E. PEQUENO
16 - ESQ. 18-2523-C

5 - ESQUADRO IT/ST Nº 5
9 - ESQ. 18-0525-C (ou CANTO CR 0182)
13 - ESQ. 18-1414-C
17 - ESQ. SA 35 CORTADO PEQUENO

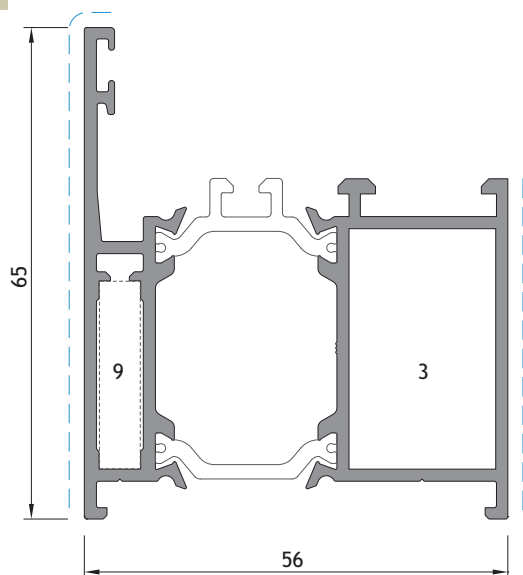

IT 07

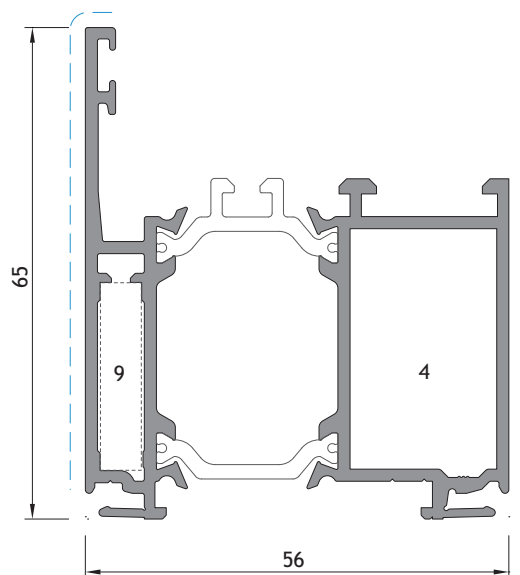

IT 57

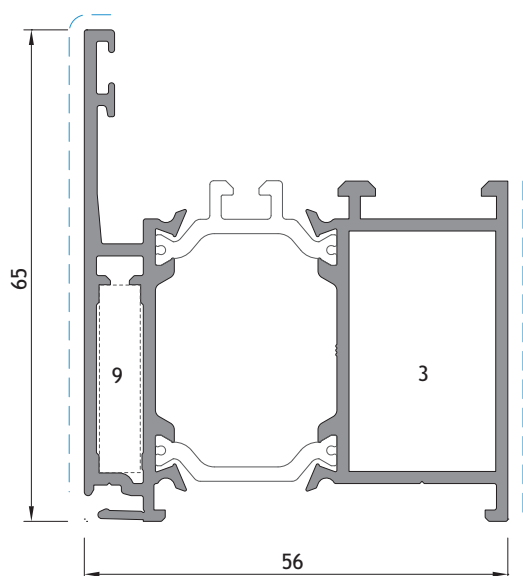

IT 67

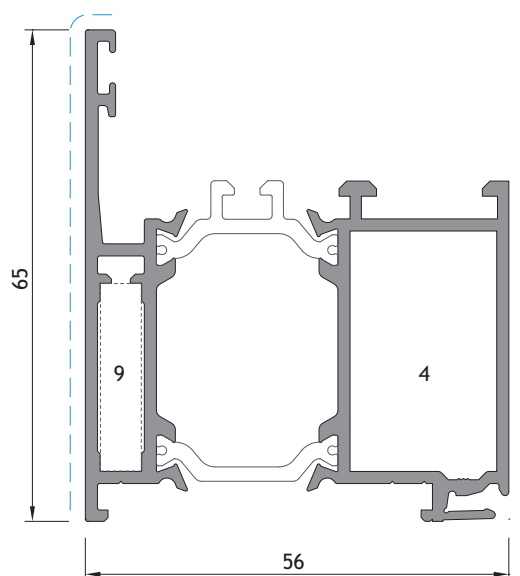

IT 47

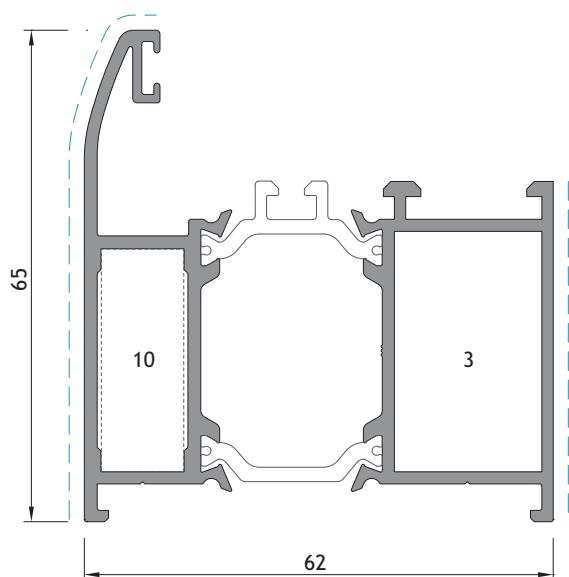

IT 56

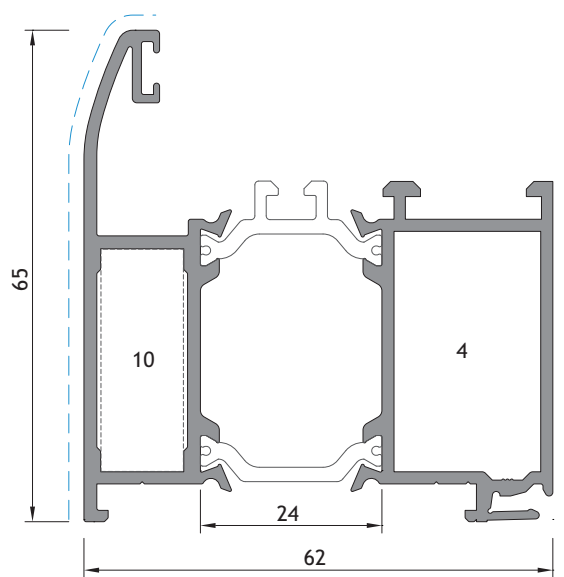

IT 69

1 - ESQUADRO IT/ST Nº 1
 6 - ESQUADRO IT/ST Nº 6
 10 - ESQUADRO 18-1130-C
 14 - ESQUADRO 1108
 18 - UNIÃO T. SA 2001G

2 - ESQUADRO IT/ST Nº 2
 7 - ESQ. 18-0512-C (ou CANTO CR 0018)
 11 - ESQUADRO AT ESPECIAL GRANDE
 15 - ESQUADRO 26-2537-140
 19 - UNIÃO T. SA 2001XP

3 - ESQUADRO IT/ST Nº 3

4 - ESQUADRO IT/ST Nº 4
 8 - ESQUADRO 18-1112-C
 12 - ESQ. AT E. PEQUENO
 16 - ESQ. 18-2523-C

5 - ESQUADRO IT/ST Nº 5
 9 - ESQ. 18-0525-C (ou CANTO CR 0182)
 13 - ESQ. 18-1414-C
 17 - ESQ. SA 35 CORTADO PEQUENO

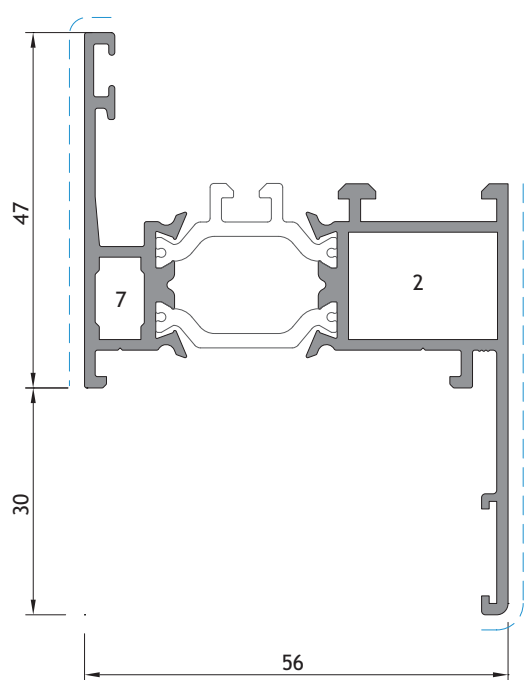

IT 81

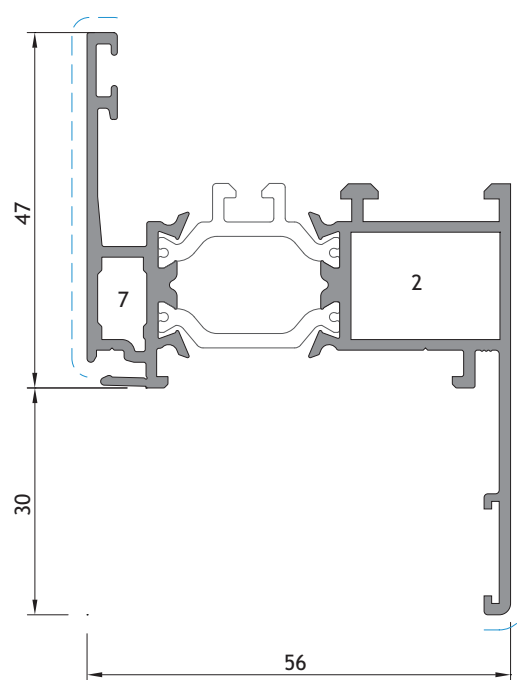

IT 61

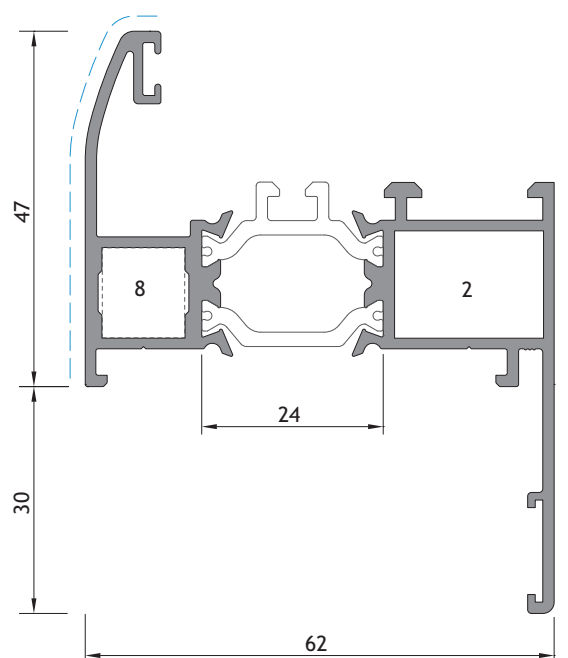

IT 21

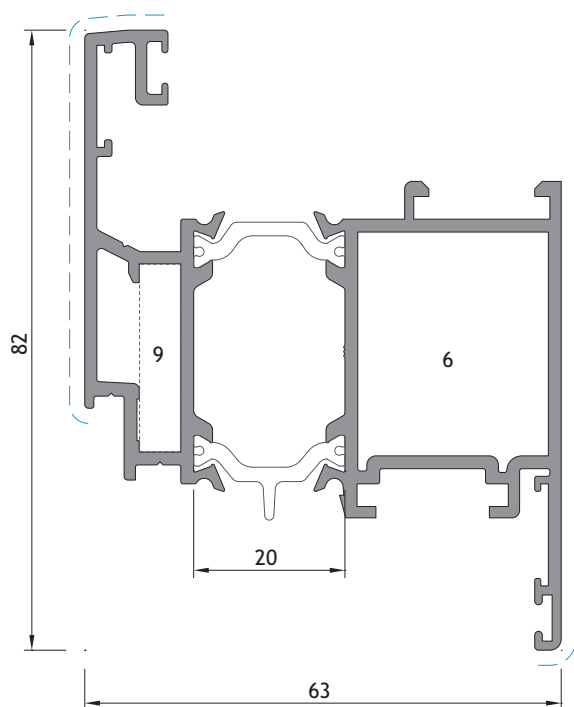

IT 11

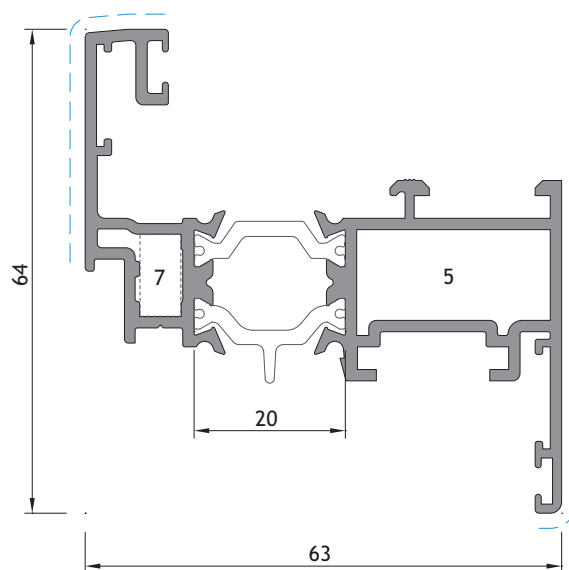

IT 02

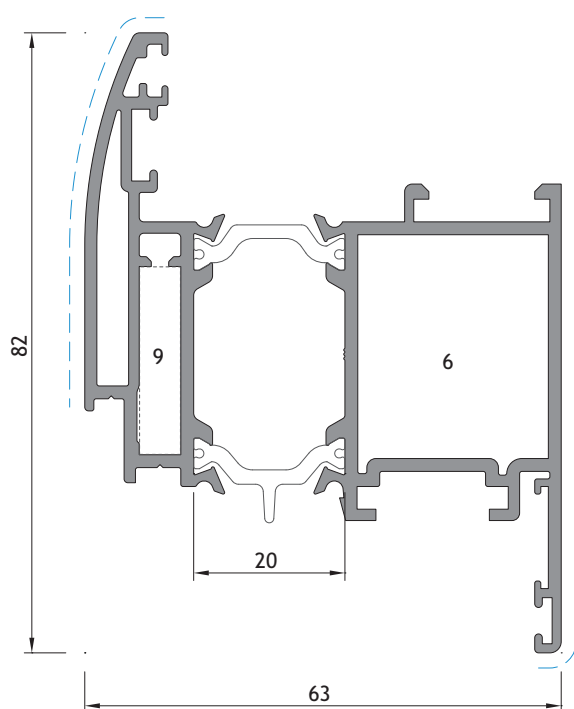

IT 88

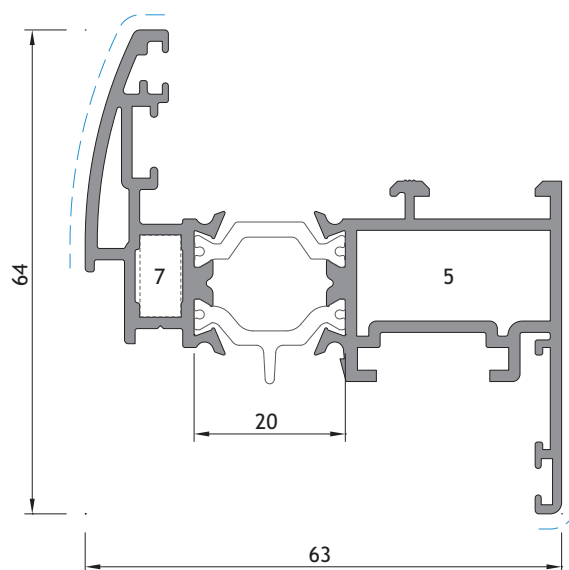

IT 85

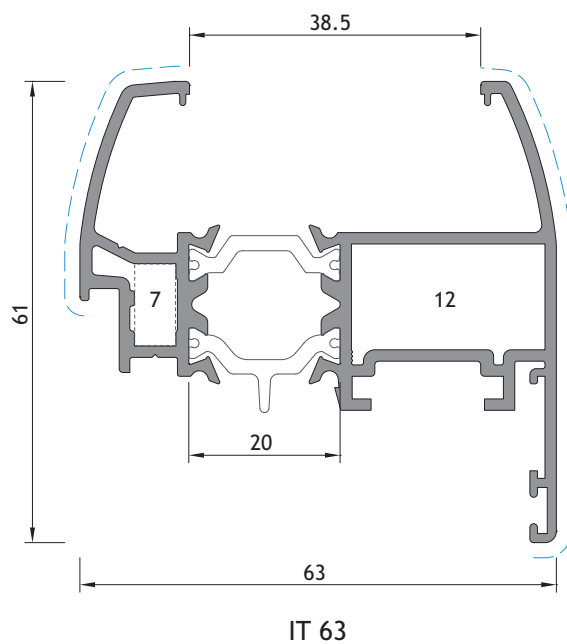
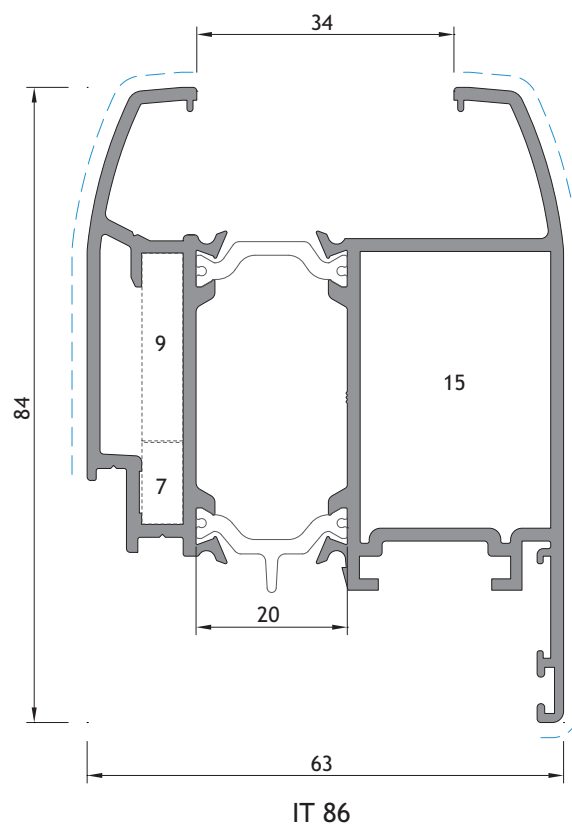
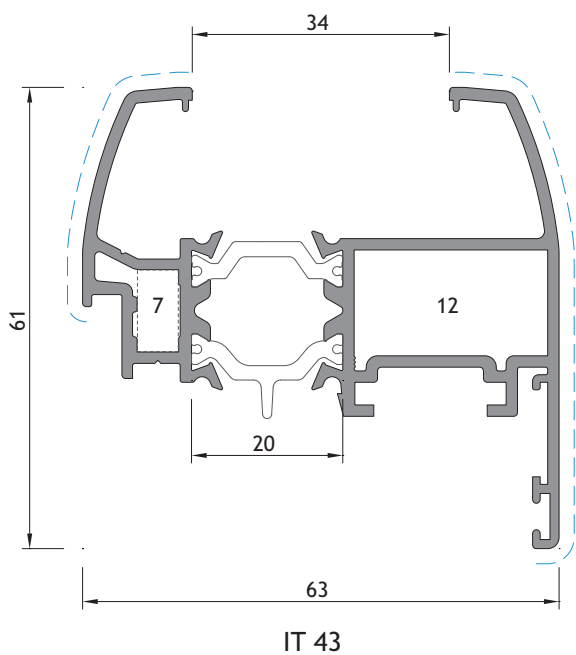

1 - ESQUADRO IT/ST Nº 1
6 - ESQUADRO IT/ST Nº 6
10 - ESQUADRO 18-1130-C
14 - ESQUADRO 1108
18 - UNIÃO T. SA 2001G

2 - ESQUADRO IT/ST Nº 2
7 - ESQ. 18-0512-C (ou CANTO CR 0018)
11 - ESQUADRO AT ESPECIAL GRANDE
15 - ESQUADRO 26-2537-140
19 - UNIÃO T. SA 2001XP

3 - ESQUADRO IT/ST Nº 3
4 - ESQUADRO IT/ST Nº 4
8 - ESQUADRO 18-1112-C
12 - ESQ. AT E. PEQUENO
16 - ESQ. 18-2523-C

5 - ESQUADRO IT/ST Nº 5
9 - ESQ. 18-0525-C (ou CANTO CR 0182)
13 - ESQ. 18-1414-C
17 - ESQ. SA 35 CORTADO PEQUENO

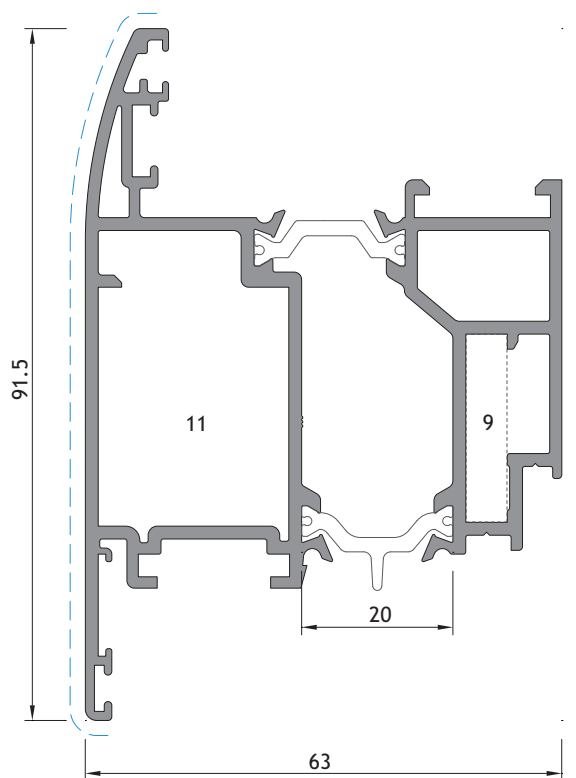

IT 09

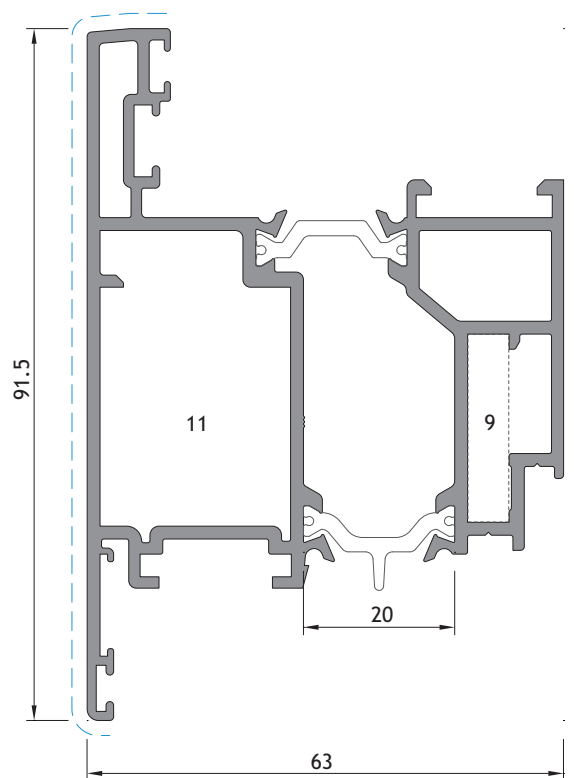

IT 12

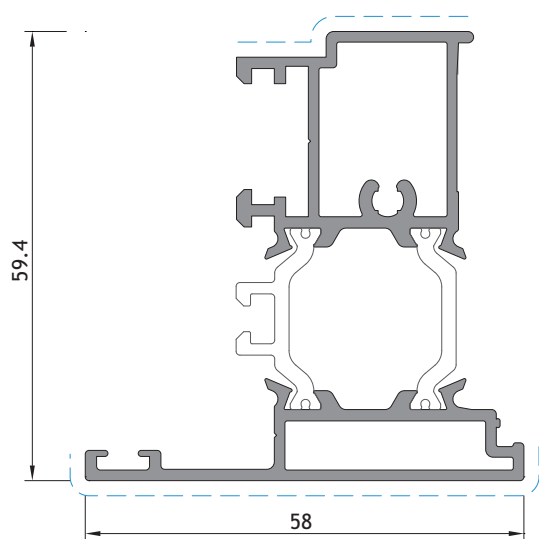

IT 06

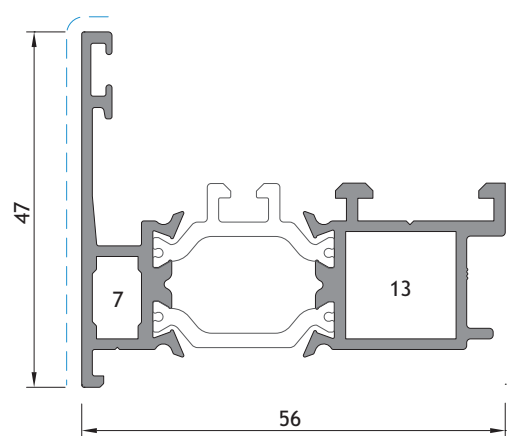

IT 83

1 - ESQUADRO IT/ST Nº 1
 6 - ESQUADRO IT/ST Nº 6
 10 - ESQUADRO 18-1130-C
 14 - ESQUADRO 1108
 18 - UNIÃO T. SA 2001G

2 - ESQUADRO IT/ST Nº 2
 7 - ESQ. 18-0512-C (ou CANTO CR 0018)
 11 - ESQUADRO AT ESPECIAL GRANDE
 15 - ESQUADRO 26-2537-140
 19 - UNIÃO T. SA 2001XP

3 - ESQUADRO IT/ST Nº 3

4 - ESQUADRO IT/ST Nº 4
 8 - ESQUADRO 18-1112-C
 12 - ESQ. AT E. PEQUENO
 16 - ESQ. 18-2523-C

5 - ESQUADRO IT/ST Nº 5
 9 - ESQ. 18-0525-C (ou CANTO CR 0182)
 13 - ESQ. 18-1414-C
 17 - ESQ. SA 35 CORTADO PEQUENO



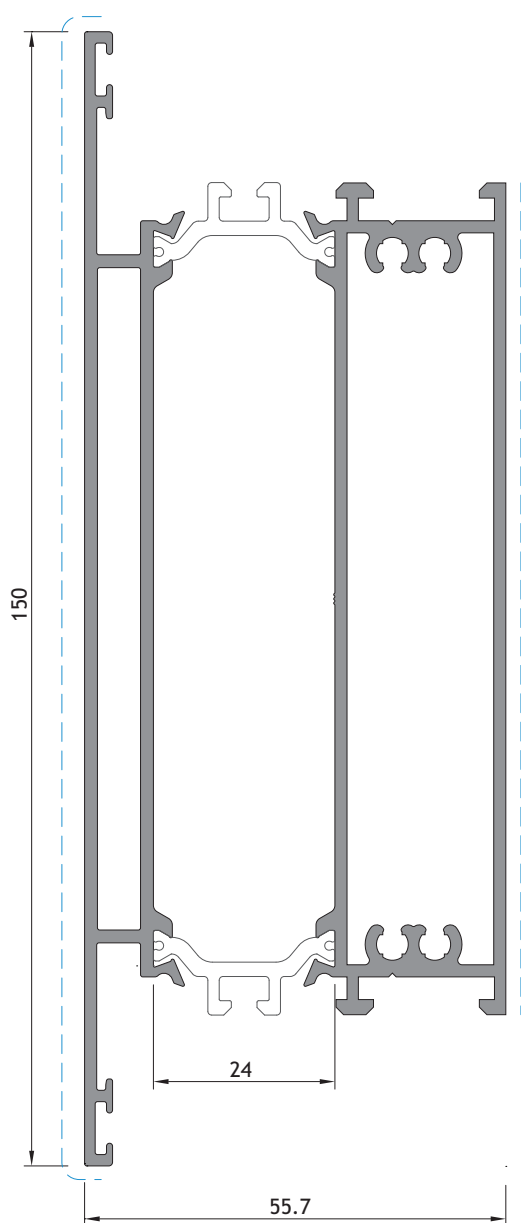

IT 14

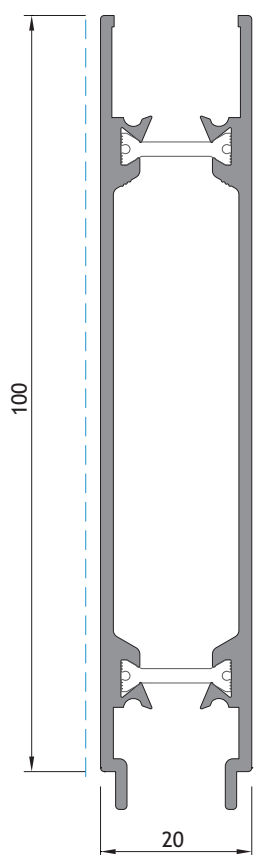

AT 16

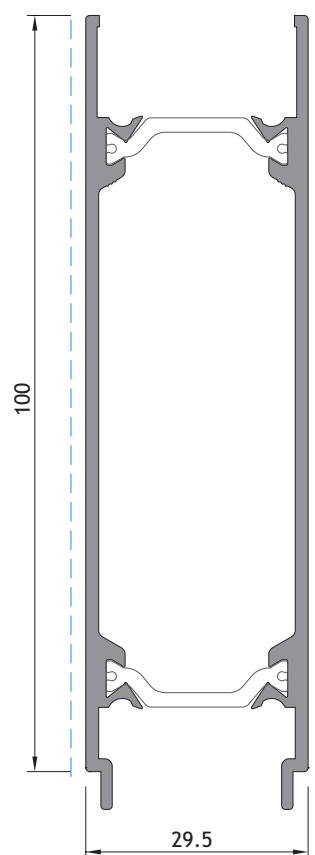

LT 16



1 - ESQUADRO IT/ST Nº 1
6 - ESQUADRO IT/ST Nº 6
10 - ESQUADRO 18-1130-C
14 - ESQUADRO 1108
18 - UNIÃO T. SA 2001G

2 - ESQUADRO IT/ST Nº 2
7 - ESQ. 18-0512-C (ou CANTO CR 0018)
11 - ESQUADRO AT ESPECIAL GRANDE
15 - ESQUADRO 26-2537-140
19 - UNIÃO T. SA 2001XP

3 - ESQUADRO IT/ST Nº 3
4 - ESQUADRO IT/ST Nº 4
8 - ESQUADRO 18-1112-C
12 - ESQ. AT E. PEQUENO
16 - ESQ. 18-2523-C

5 - ESQUADRO IT/ST Nº 5
9 - ESQ. 18-0525-C (ou CANTO CR 0182)
13 - ESQ. 18-1414-C
17 - ESQ. SA 35 CORTADO PEQUENO

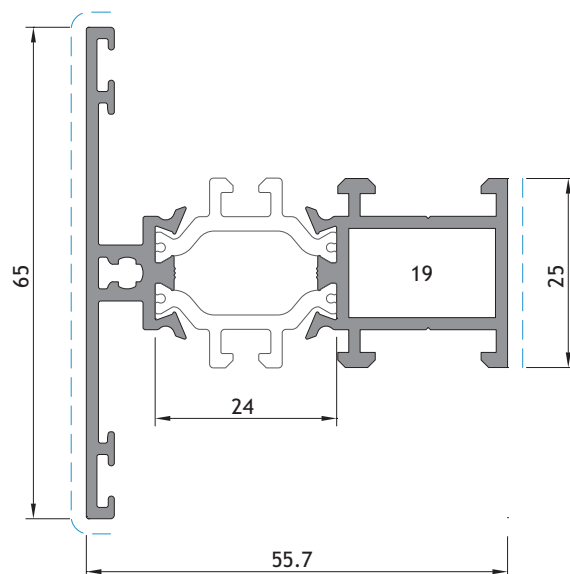

IT 20

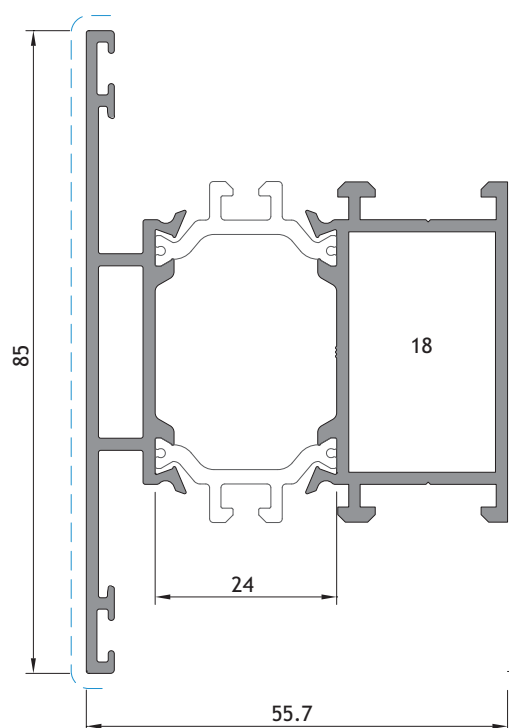

IT 36

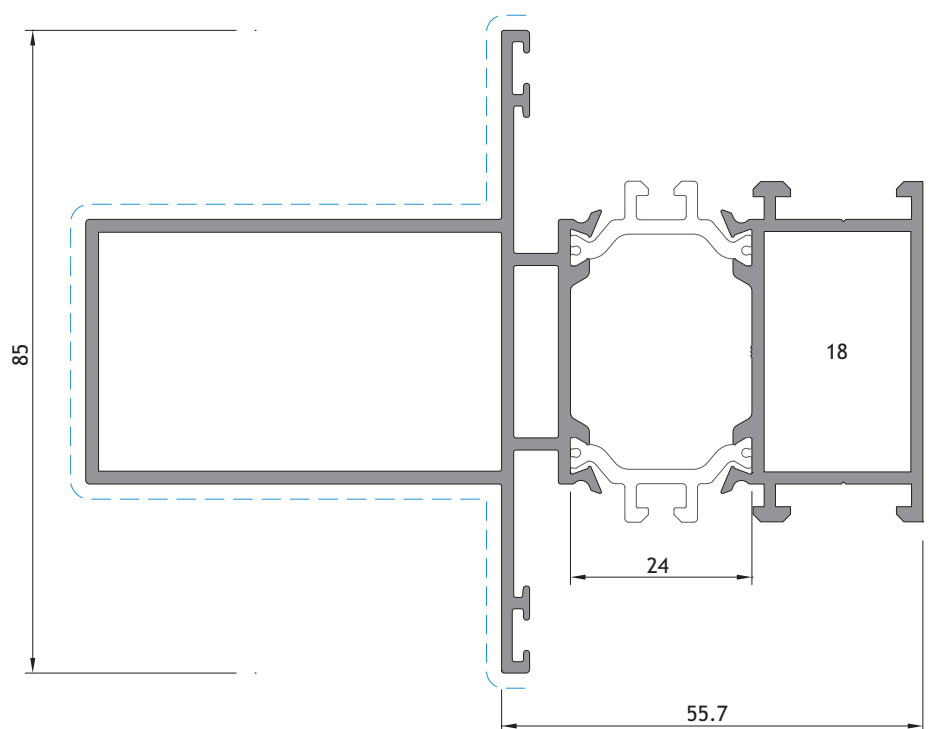

IT 19

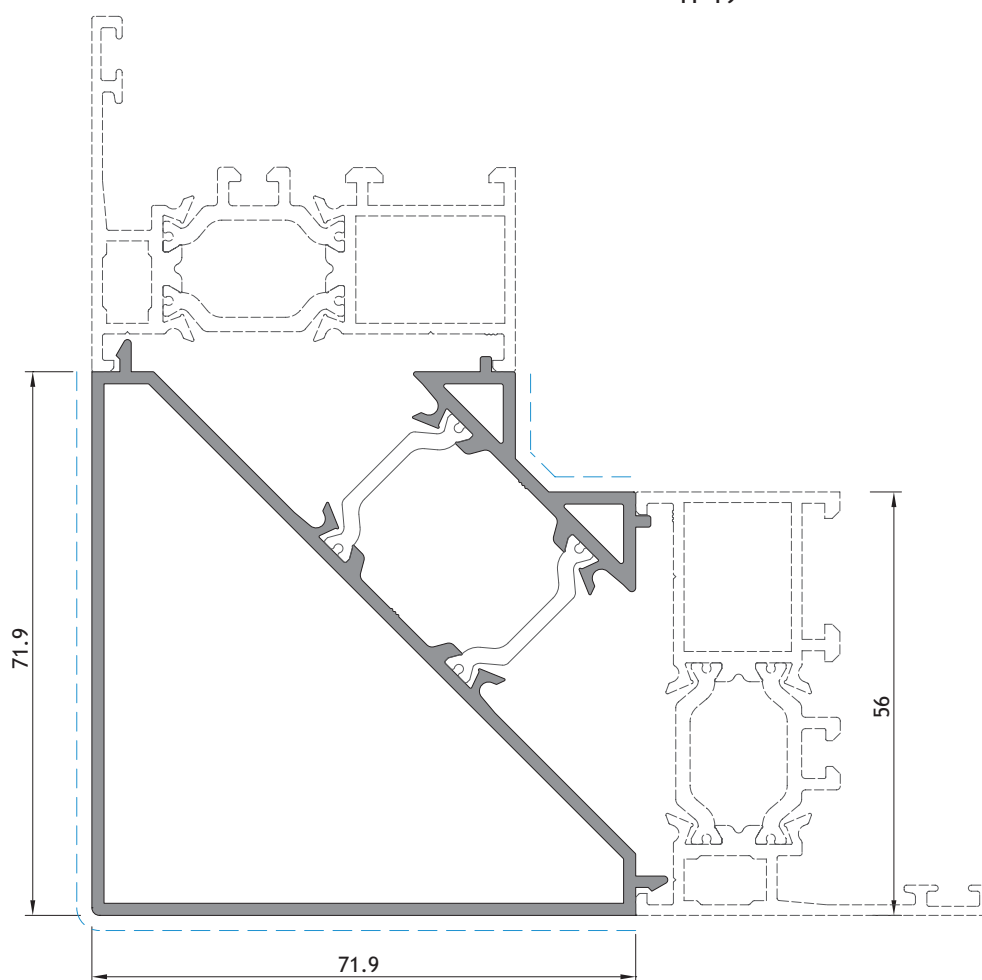

IS 55



1 - ESQUADRO IT/ST Nº 1
6 - ESQUADRO IT/ST Nº 6
10 - ESQUADRO 18-1130-C
14 - ESQUADRO 1108
18 - UNIÃO T. SA 2001G

2 - ESQUADRO IT/ST Nº 2
7 - ESQ. 18-0512-C (ou CANTO CR 0018)
11 - ESQUADRO AT ESPECIAL GRANDE
15 - ESQUADRO 26-2537-140
19 - UNIÃO T. SA 2001XP

3 - ESQUADRO IT/ST Nº 3
8 - ESQUADRO 18-1112-C
12 - ESQ. AT E. PEQUENO
16 - ESQ. 18-2523-C

5 - ESQUADRO IT/ST Nº 5
9 - ESQ. 18-0525-C (ou CANTO CR 0182)
13 - ESQ. 18-1414-C
17 - ESQ. SA 35 CORTADO PEQUENO

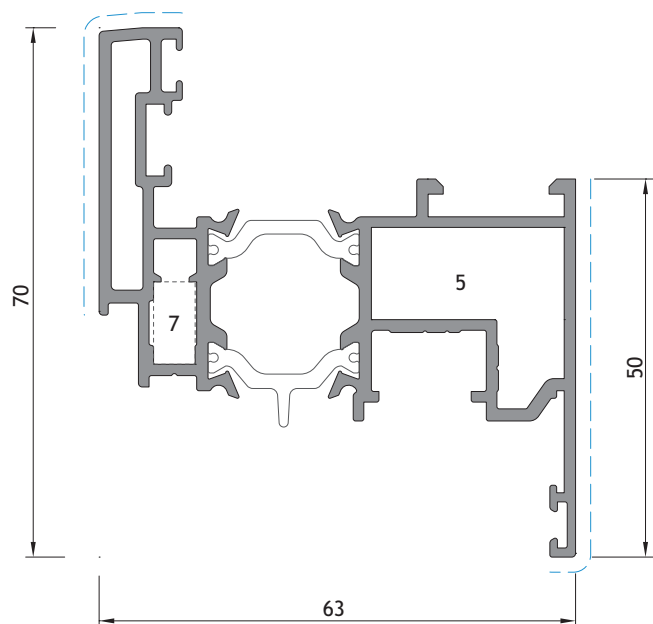

IT 04

(Canal 16 | Channel 16 | Chenal 16)

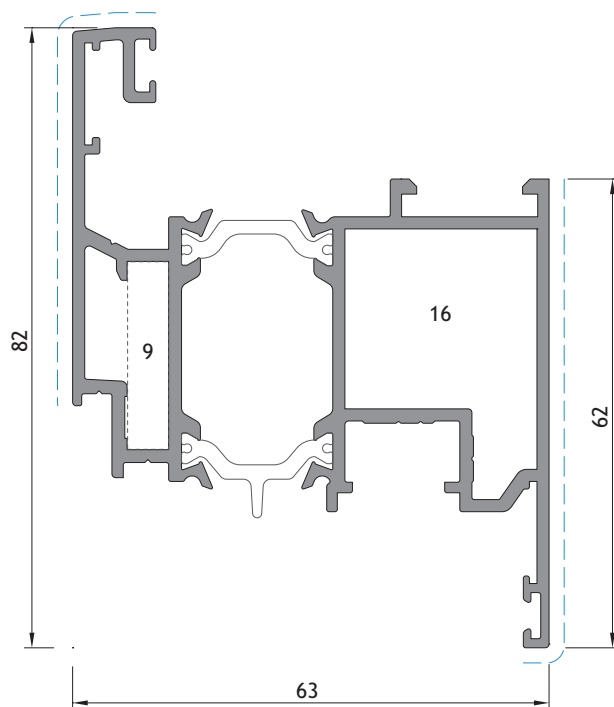

IT 05

(Canal 16 | Channel 16 | Chenal 16)

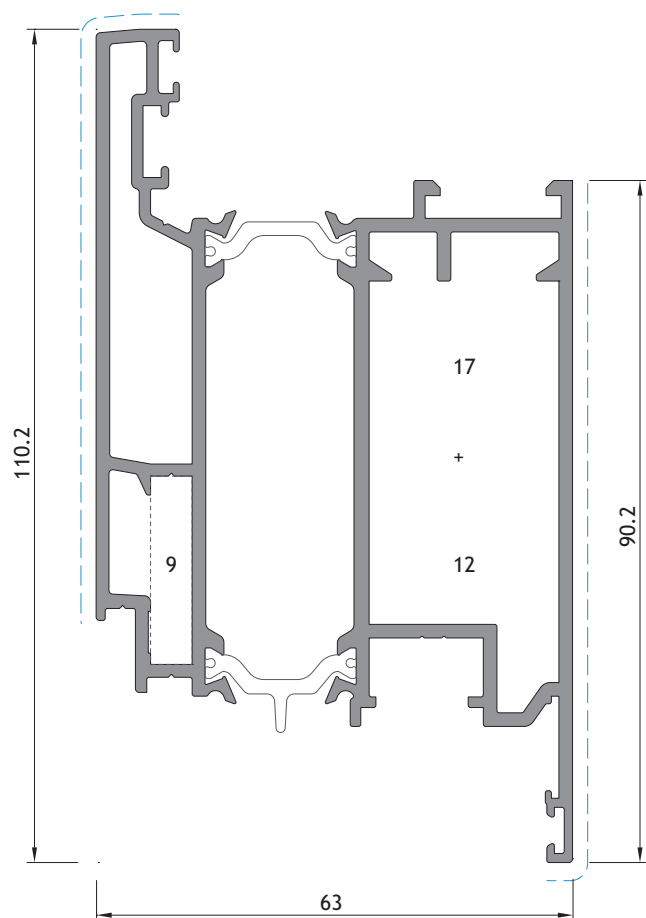

IT 66

(Canal 16 | Channel 16 | Chenal 16)

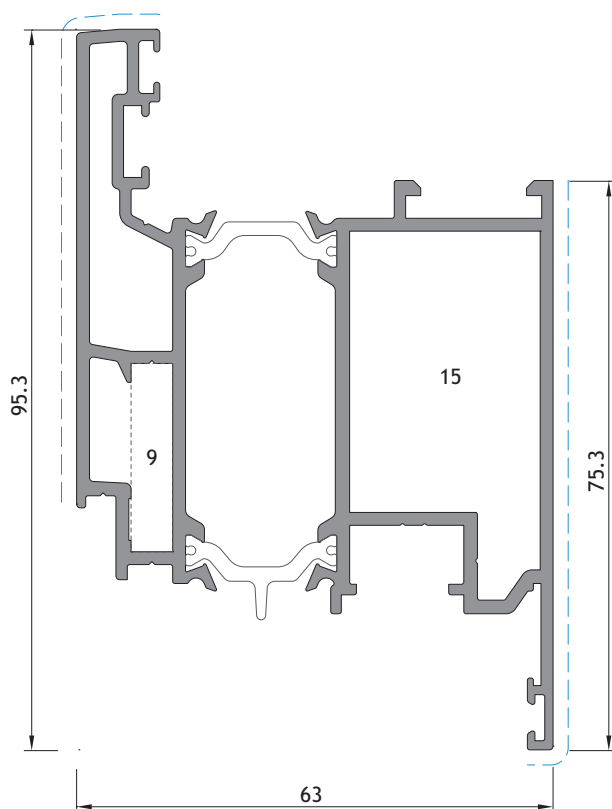

IT 48

(Canal 16 | Channel 16 | Chenal 16)

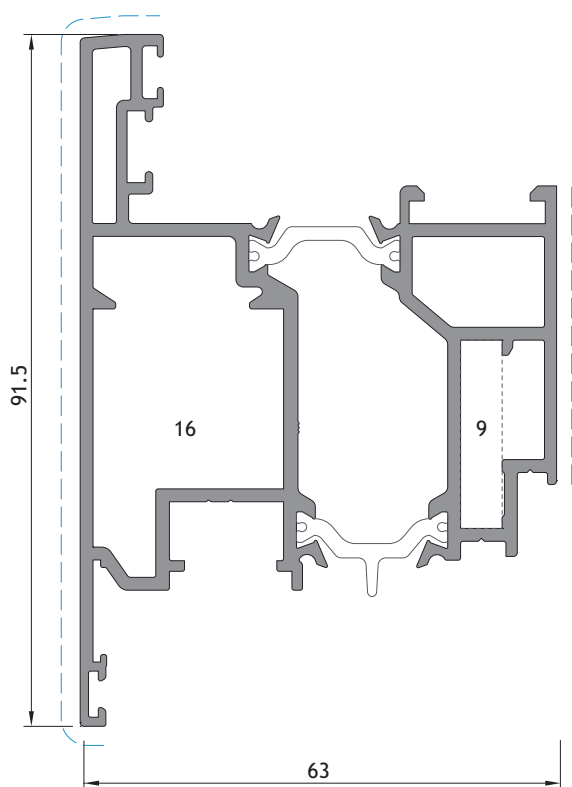

IT 13
(Canal 16 | Channel 16 | Chenal 16)

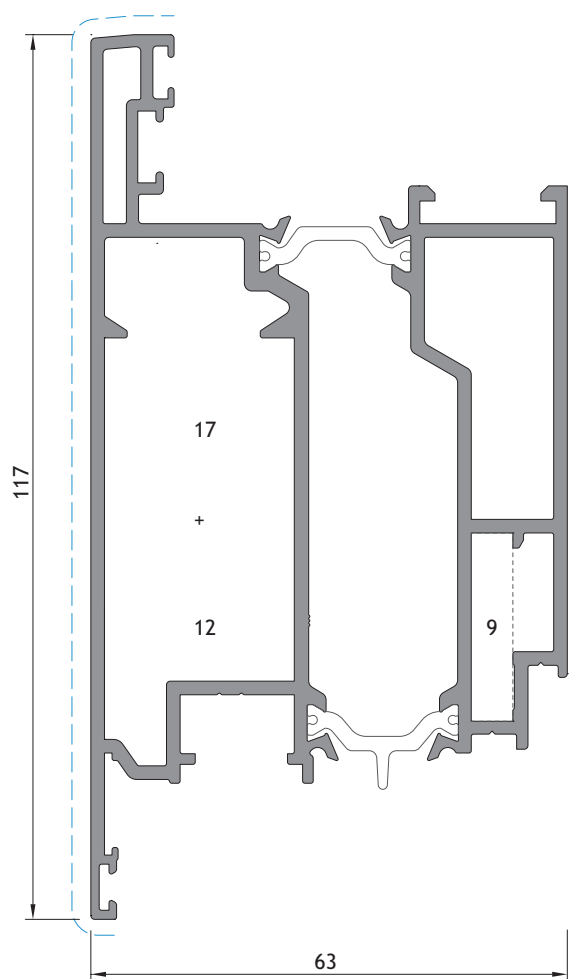

IT 23
(Canal 16 | Channel 16 | Chenal 16)

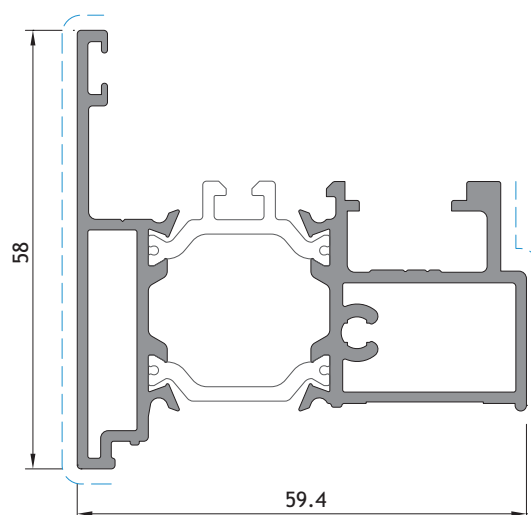

IT 77
(Canal 16 | Channel 16 | Chenal 16)

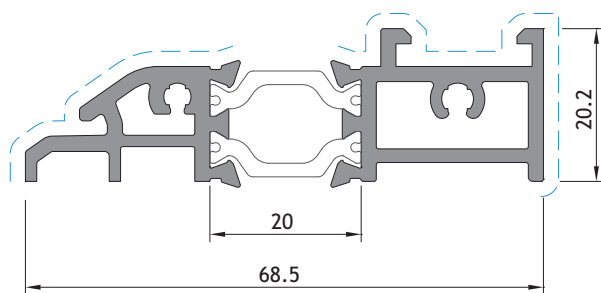

IT 49

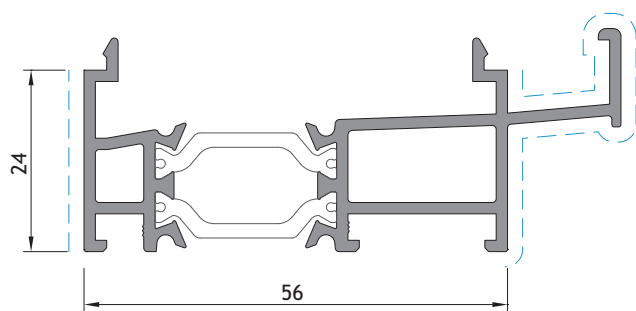

IT 27

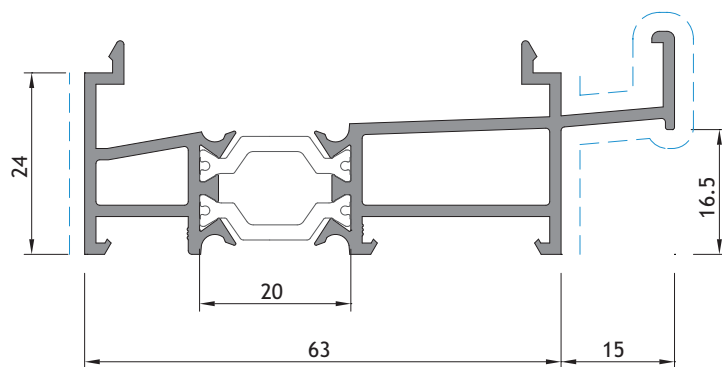

IT 76

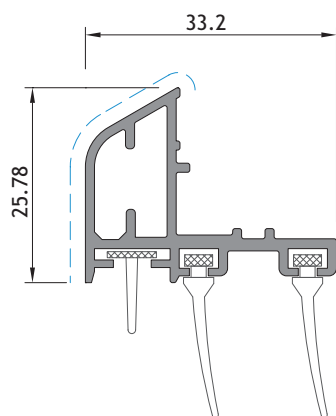

IT 32

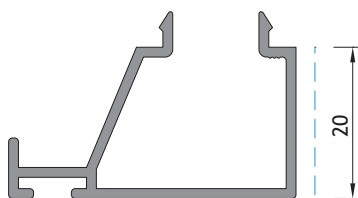

AT 59

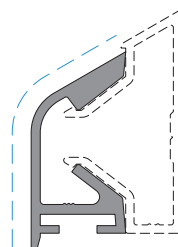

SA 32

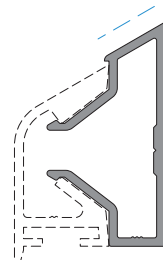

SA 31

1 - ESQUADRO IT/ST Nº 1
6 - ESQUADRO IT/ST Nº 6
10 - ESQUADRO 18-1130-C
14 - ESQUADRO 1108
18 - UNIÃO T. SA 2001G

2 - ESQUADRO IT/ST Nº 2
7 - ESQ. 18-0512-C (ou CANTO CR 0018)
11 - ESQUADRO AT ESPECIAL GRANDE
15 - ESQUADRO 26-2537-140
19 - UNIÃO T. SA 2001XP

3 - ESQUADRO IT/ST Nº 3
4 - ESQUADRO IT/ST Nº 4
8 - ESQUADRO 18-1112-C
12 - ESQ. AT E. PEQUENO
16 - ESQ. 18-2523-C

5 - ESQUADRO IT/ST Nº 5
9 - ESQ. 18-0525-C (ou CANTO CR 0182)
13 - ESQ. 18-1414-C
17 - ESQ. SA 35 CORTADO PEQUENO



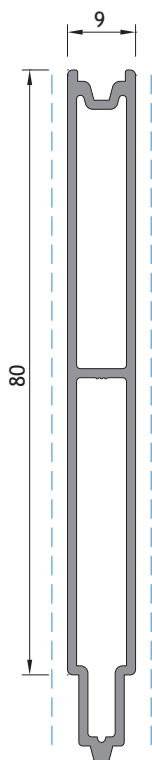

SB 64

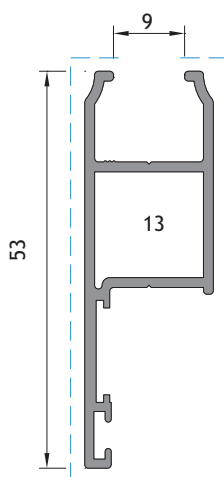

SB 63



LT 33



AT 30



SA 33

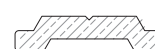

AT 33

PERFIL EM POLIAMIDA - NÃO UTILIZAR EM FERRAGENS OSCILO-BATENTE E/OU OSCILO-PARALELA
 PROFILE IN POLYAMIDE - DO NOT USE IN TILT-AND-TURN AND/OR TILT-AND-SLIDE HARDWARE
 PROFIL EN POLYAMIDE - NE PAS UTILISER DANS LES ACCESSOIRES OSCILLO-BATTANT ET/OU OSCILLO-COULISSANT

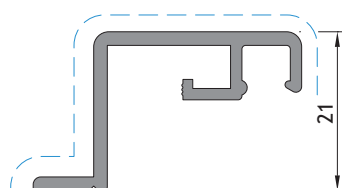

PB 32

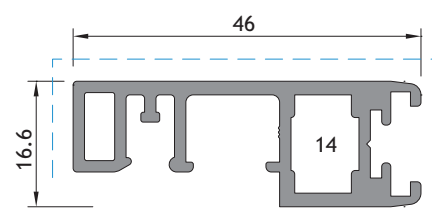

KY 86

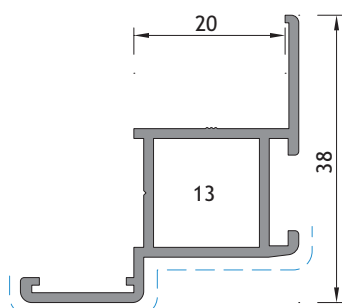

KY 69

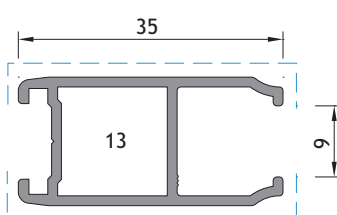

KY 70

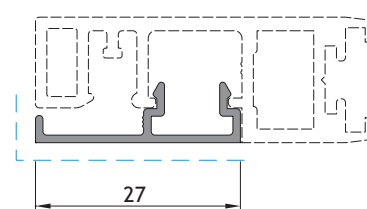

KY 87

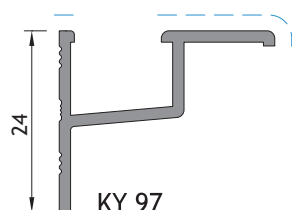

KY 97

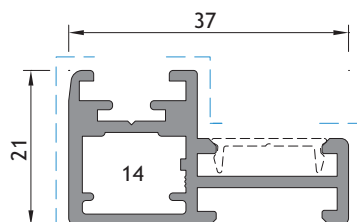

KY 84

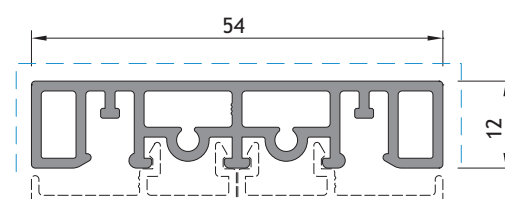

KY 89



1 - ESQUADRO IT/ST Nº 1
 6 - ESQUADRO IT/ST Nº 6
 10 - ESQUADRO 18-1130-C
 14 - ESQUADRO 1108
 18 - UNIÃO T. SA 2001G

2 - ESQUADRO IT/ST Nº 2
 7 - ESQ. 18-0512-C (ou CANTO CR 0018)
 11 - ESQUADRO AT ESPECIAL GRANDE
 15 - ESQUADRO 26-2537-140
 19 - UNIÃO T. SA 2001XP

3 - ESQUADRO IT/ST Nº 3
 8 - ESQUADRO 18-1112-C
 12 - ESQ. AT E. PEQUENO
 16 - ESQ. 18-2523-C

4 - ESQUADRO IT/ST Nº 4
 9 - ESQ. 18-0525-C (ou CANTO CR 0182)
 13 - ESQ. 18-1414-C
 17 - ESQ. SA 35 CORTADO PEQUENO

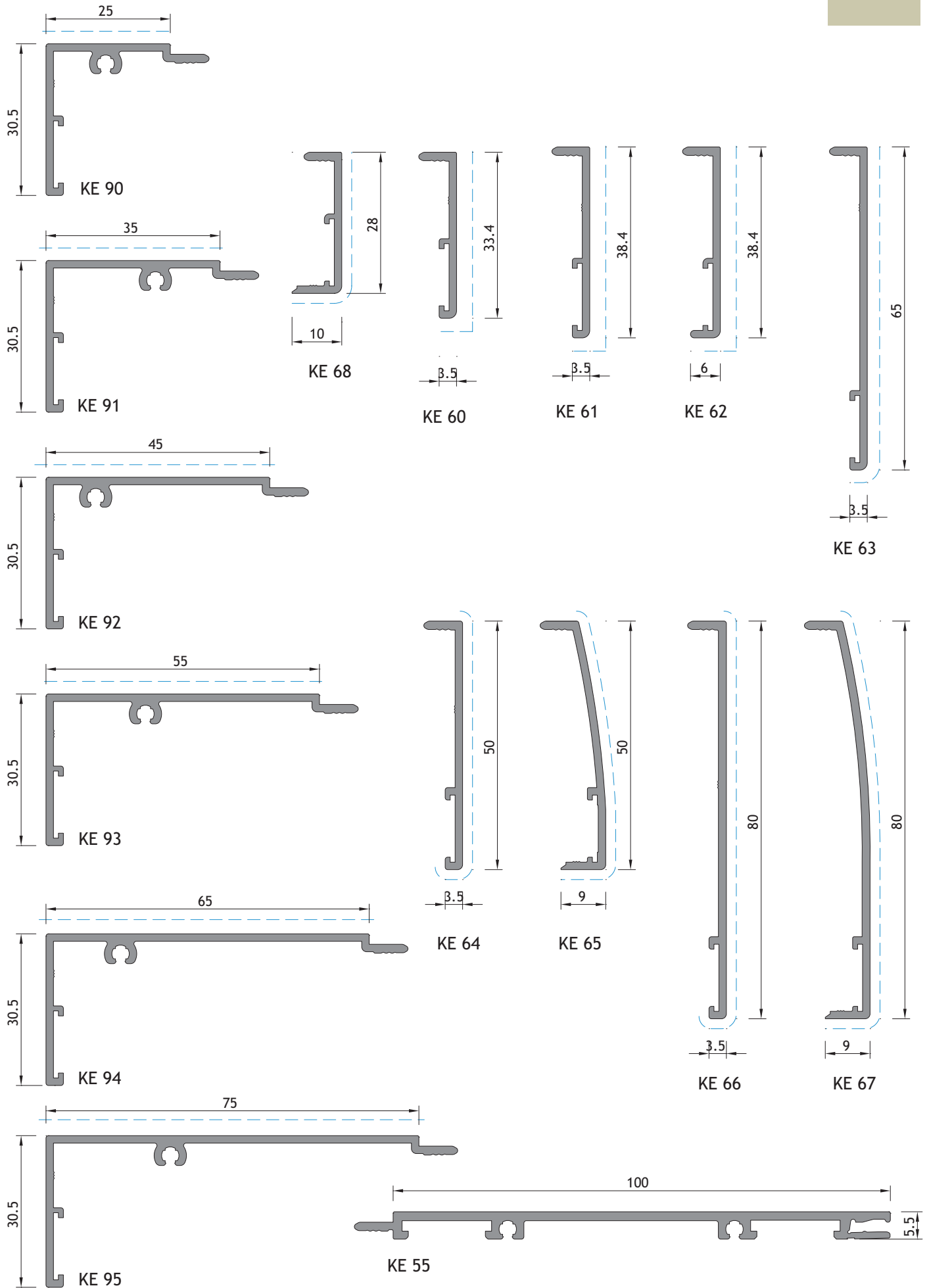

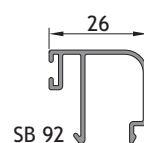
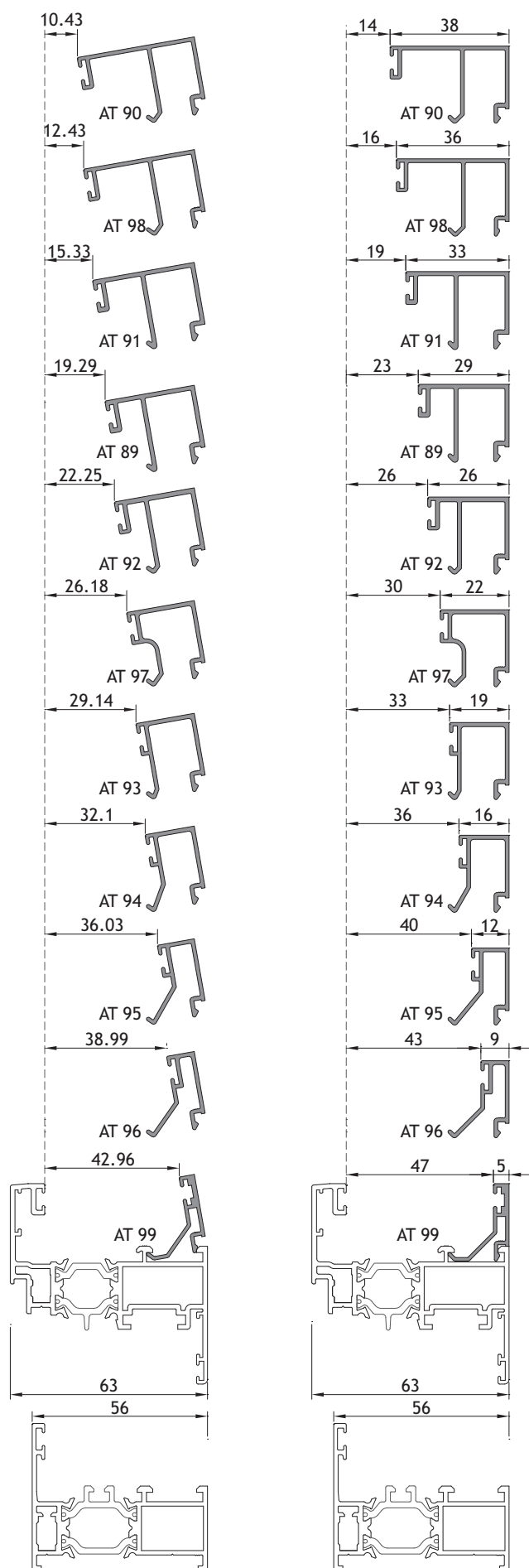

SB 92

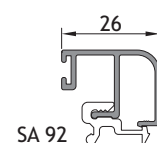

SA 92

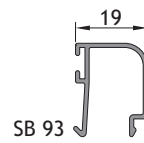

SB 93

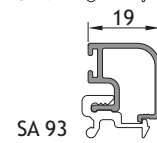

SA 93

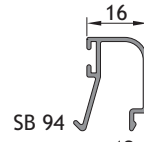

SB 94

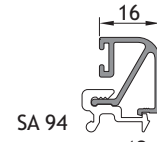

SA 94

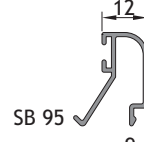

SB 95

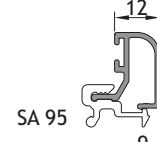

SA 95

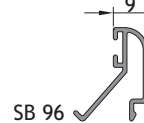

SB 96

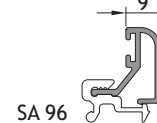

SA 96



MOLA EURO 2000 Ref: 228165
 Para aplicar com os bites com referência SA Lacados
 To apply with the glazing beads with reference SA Powder coated
 Pour appliquer avec les parcloses avec référence SA laqué



PRESILHA SA 71 EM ALUMÍNIO Ref: 207202
 Para aplicar com os bites com referência SA
 To apply with the glazing beads with reference SA
 Pour appliquer avec les parcloses avec référence SA



TABELA DE BITES PARA PERFIS DE 52mm

GLAZING BEADS SCHEDULE FOR 52mm PROFILES

TABLE DES PARCLOSES POUR PROFILS DE 52mm

VEDANTE EXTERIOR OUTER GASKET JOINT EXTÉRIEUR	ESPESSURA DO VIDRO THICKNESS OF GLASS ÉPAISSEUR DU VERRE	VEDANTE INTERIOR INNER GASKET JOINT INTÉRIEUR	BITE GLAZING BEAD PARCLOSE	
			RETO STRAIGHT DROITE	REDONDO ROUND ARRONDIE
2035	4	2035	AT 90	
2003	6	2035	AT 90	
2003	6	2073	AT 98	
2003	7	2034	AT 90	
2003	8	2073	AT 90	
2003	8	2035	AT 98	
2003	9	2034	AT 98	
2003	10	2073	AT 98	
2034	10	2035	AT 91	
2003	11	2035	AT 91	
2034	11	2034	AT 91	
2003	12	2034	AT 91	
2003	13	2073	AT 91	
2003	14	2042	AT 98	
2003	16	2037	AT 92	SA/SB 92
2035	16	2035	AT 92	SA/SB 92
2034	17	2035	AT 92	SA/SB 92
2055	17	2073	AT 89	
2003	18	2035	AT 92	SA/SB 92
2034	18	2034	AT 92	SA/SB 92
2003	19	2034	AT 92	SA/SB 92
2003	20	2037	AT 97	SA 97
2035	20	2035	AT 97	SA 97
2003	22	2035	AT 97	SA 97
2034	22	2034	AT 97	SA 97
2003	24	2034	AT 97	SA 97
2003	25	2035	AT 93	SA/SB 93
2034	25	2034	AT 93	SA/SB 93
2003	26	2034	AT 93	SA/SB 93
2034	27	2073	AT 93	SA/SB 93
2003	28	2035	AT 94	SA/SB 94
2003	29	2034	AT 94	SA/SB 94
2003	30	2073	AT 94	SA/SB 94
2003	32	2035	AT 95	SA/SB 95
2003	33	2034	AT 95	SA/SB 95
2003	34	2073	AT 95	SA/SB 95
2003	35	2042	AT 95	SA/SB 95
2003	36	2034	AT 96	SA/SB 96
2003	37	2073	AT 96	SA/SB 96
2034	38	2035	AT 96	SA/SB 96
2003	39	2035	AT 99	
2003	40	2034	AT 99	
2003	41	2073	AT 99	
2003	42	2042	AT 99	
2042	43	2042	AT 99	

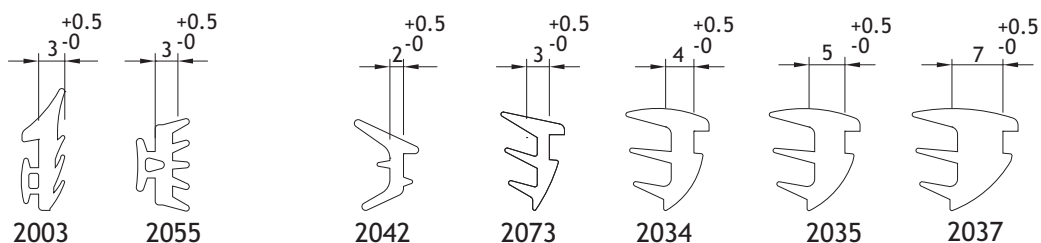



Acessórios

Accessories

Accessoires





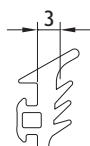

2003

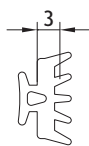
Material: EPDM
Rolo: 100m

2055

Material: EPDM
Rolo: 200m208350
208289JUNTA DE VEDAÇÃO EXTERIOR 2003
JUNTA DE BATENTE 2055

2001

Material: EPDM
(Caixa: 8 rolosx50m)

2051

Material com 2 durezas
(Zona de batente: E.P.D.M. esponjoso)
(Base: E.P.D.M. de 70° SHORE)
(Rolo: 300m (150m+150m))

2071

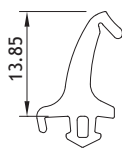
Material: EPDM, 2 durezas
(Caixa: 300m)208274
208008
208143JUNTA DE ESTANQUIDADE 2001
JUNTA DE ESTANQUIDADE 2051
JUNTA DE ESTANQUIDADE 2071Material: EPDM
(Caixa: 150m)

208486

JUNTA DE VEDAÇÃO CENTRAL 2105.N

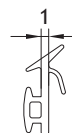

2112

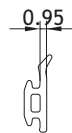
(Material: EPDM)
(Rolo: 200m)

2412

(Material: EPDM)
(Rolo: 200m)

Aplicação facultativa

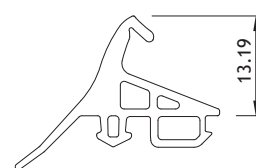
208278
208184JUNTA DE ESTANQUIDADE 2112
JUNTA DE ESTANQUIDADE 2412Material: EPDM
(Barras: 6,3m)

208144

JUNTA DE VEDAÇÃO CENTRAL 2305

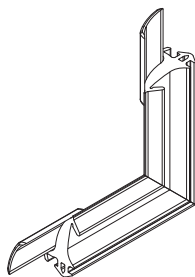
Para VD 2105N
Material: EPDM

213290

CANTO VULCANIZADO 2105.1N

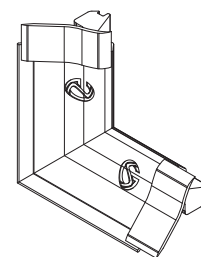
Para VD 2305
Material: EPDM

213310

CANTO VULCANIZADO 2305.1

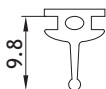
Para o perfil SA 32
(Rolo: 100m)

208246

JUNTA ENCAIXE 1140 PRT

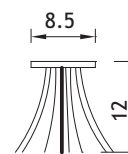
Para os perfis SA32 ou IT 32
(Rolo: 300m)

208464

JUNTA PELÚCIA 8.5x12 S-FIN

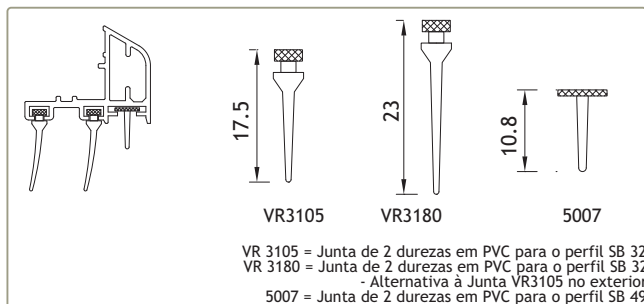

208292 JUNTA INFERIOR PORTA VR3105
 208294 JUNTA INFERIOR PORTA VR3180
 208165 JUNTA INFERIOR PORTA 5007 PRETO

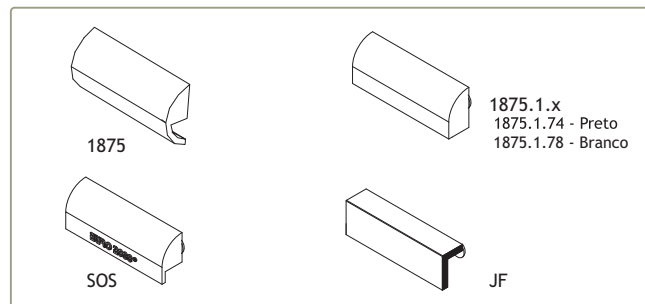

210154 GOTEIRA 1875 Br/Pr 210142 GOT. C/VÁLV. 1875.1.74
 210280 GOTEIRA SOS C/ VÁLV. Br/Pr. 210144 GOT. C/VÁLV. 1875.1.78
 210146 GOTEIRA JF

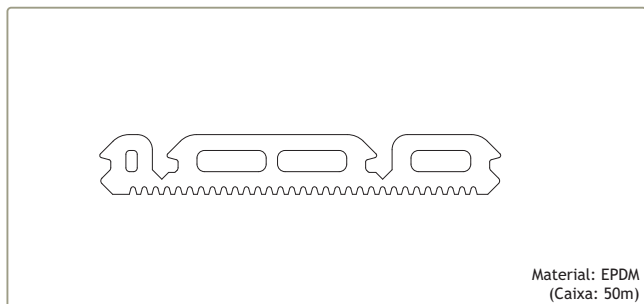

208145 JUNTA DE REMATE PAREDE 2079

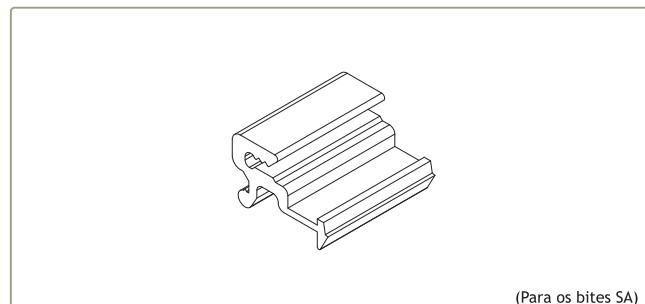

228165 MOLA EURO 2000

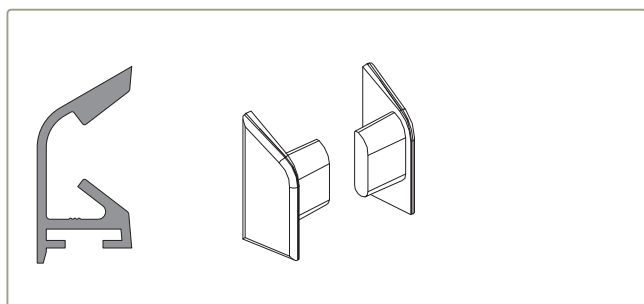

212346 CONJ. TAPA-TOPOS SA 32 Br/Pr

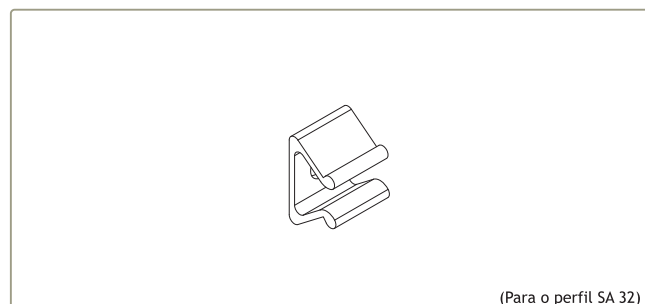

228181 MOLA PARA PINGADEIRA

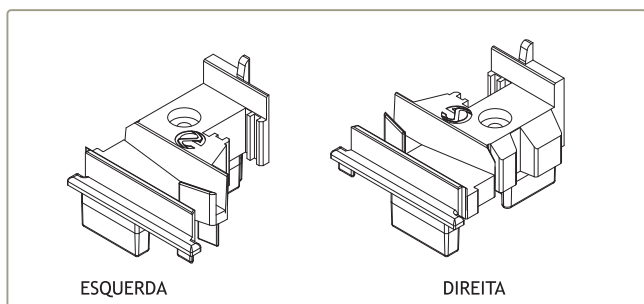

212063 CONJUNTO TOPO INVERSOR IT Preto

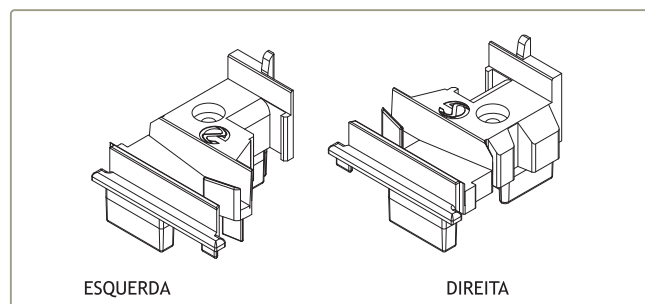

212141 CONJUNTO TOPO INVERSOR IT CANAL 16 Preto

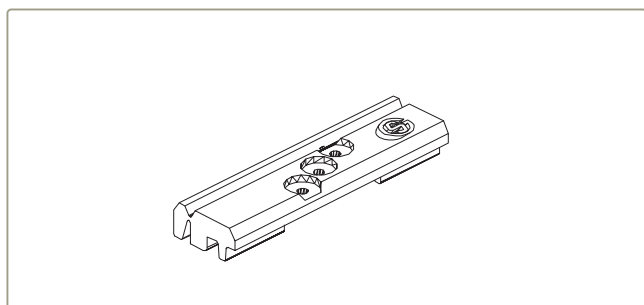

218194 CALÇO P/VIDRO EURO 2000 Nylon

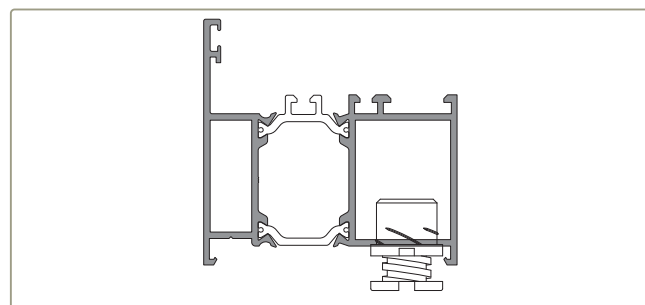

224205 NIVELADOR PEQUENO 600.01/8

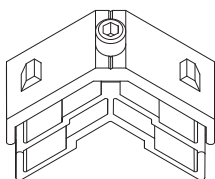

Para os perfis IT 01, 31 e 38

204137

ESQUADRO IT/ST N°1 16-1914-C

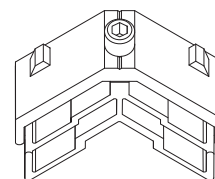

Para os perfis IT 21, 28, 41, 51, 61 e 81

204138

ESQUADRO IT/ST N°2 16-1914-D

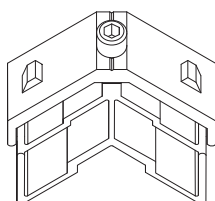

Para os perfis IT 07, 56 e 67

204139

ESQUADRO IT/ST N°3 16-1931-C

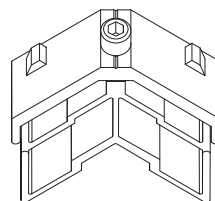

Para os perfis IT 47, 57 e 69

204141

ESQUADRO IT/ST N°4 16-1931-D

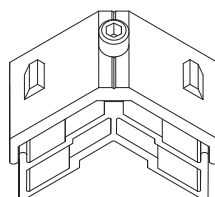

Para os perfis IT 02 e 85

204142

ESQUADRO IT/ST N°5 18-2512-140

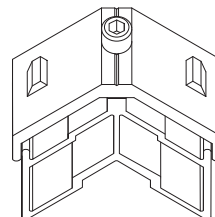

Para os perfis IT 11 e 88

204143

ESQUADRO IT/ST N°6 18-2530-140

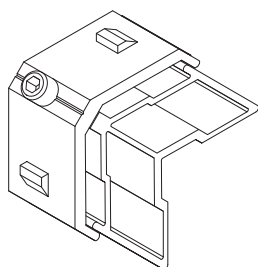

Para os perfis IT 09 e 12

204730

ESQUADRO AT E. GRANDE

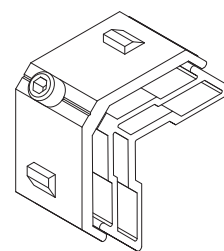

Para os perfis IT 43 e 63

204728

ESQUADRO AT E. PEQUENO

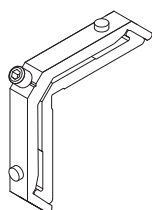

Para os perfis IT 01, 02, 31, 41, 43, 51, 61, 63, 81, 83, 85 e 86

204150

ESQUADRO 18-0512-C

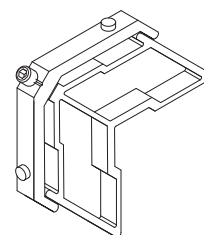

Para os perfis IT 07, 09, 11, 12, 47, 57, 67, 86 e 88

204151

ESQUADRO 18-0525 C

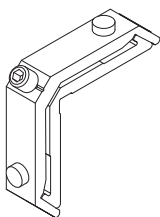

Para os perfis IT 83, SB 63, KY 69 e KY 70

204029

ESQUADRO 18-1414 C

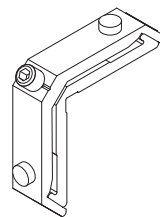

Para o perfil IT 38

204901

ESQUADRO 18-1112-C

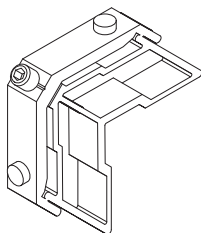

Para o perfil IT 56

204009

ESQUADRO 18-1130-C

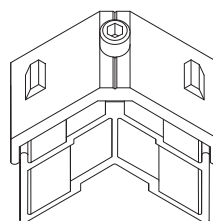

Para os perfis IT 05 e IT 13

204152

ESQUADRO 18-2523-C

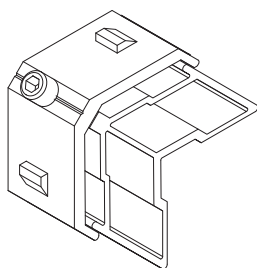

Para os perfis IT 48 e IT 86

204010

ESQUADRO 26-2537-140

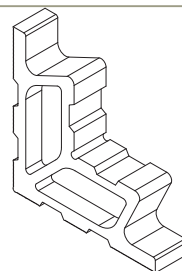

Para os perfis IT 23 e 66

204256

ESQUADRO SA 35 CORTADO PEQUENO

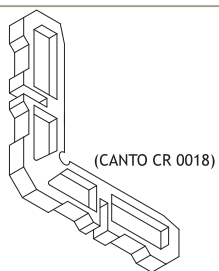

(CANTO CR 0018)

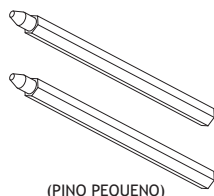

(PINO PEQUENO)

Para os perfis IT 01, 31, 41, 51, 61, e 83
Em alternativa ao ESQUADRO 18-0512-C, APENAS EM AROS FIXOS

213308

CANTO CR 0018 + PINOS PEQ.

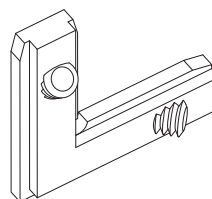

204131

ESQUADRO DE ALINHAMENTO C/ APERTO

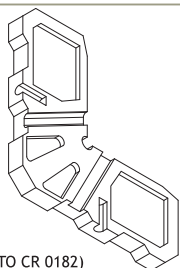

(CANTO CR 0182)

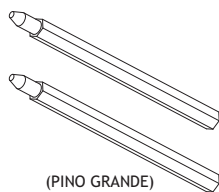

(PINO GRANDE)

Para os perfis IT 07, 47, 57 e 67
Em alternativa ao ESQUADRO 18-0525-C, APENAS EM AROS FIXOS

213309

CANTO CR 0182 + PINOS GR.

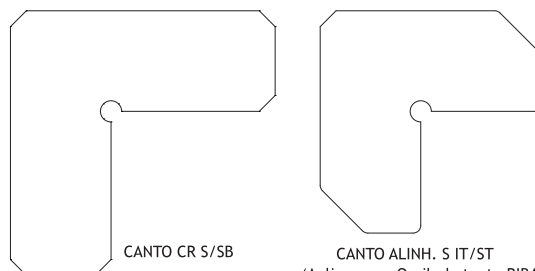

CANTO CR S/SB

CANTO ALINH. S IT/ST
(Aplicar com Oscilo-batente RIBANTA 5)

213246
213261

CANTO CR S/SB
CANTO ALINH. S IT/ST

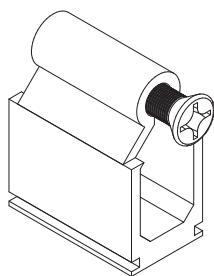

Para os perfis IT 19 e 36

232116
290037

UNIÃO TRAVESSAS SA2001 G
PARAFUSO SUPLEMENTAR P/UNIÃO SA2001 G INOX

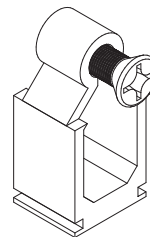

Para o perfil IT 20

232119

UNIÃO TRAVESSAS SA2001 XP

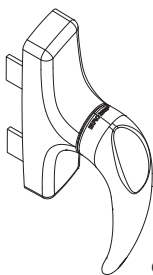

Cremone 870.2: Para janelas sem oscilo-batente
Acabamentos: Branco, Preto, Cinza, Latão, Inox ou Dourado)

200302

CREMONE MANON 870.2

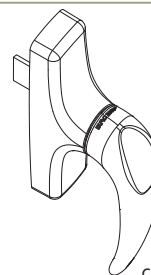

Cremone 873.2: Para janelas com oscilo-batente
Acabamentos: Branco, Preto, Cinza, Latão, Inox ou Dourado)

200315

CREMONE MANON 873.2

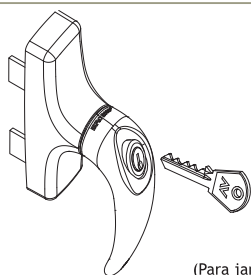

(Para janelas sem oscilo-batente
Acabamentos: Branco, Preto, Cinza, Latão, Inox ou Dourado)

200215

CREMONE MANON 870.754

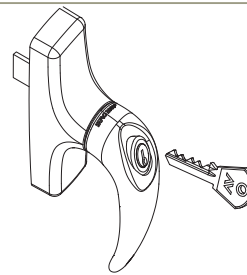

(Para janelas com oscilo-batente)
(Acabamentos: Branco, Preto, Cinza, Latão, Inox ou Dourado)

200969

CREMONE MANON 873.754

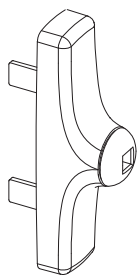

(Utilizar com a moleta 1243.599)

200405

CREMONE SEM MOLETA 870.752 Preto

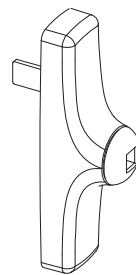

(Utilizar com a moleta 1243.599)

200406

CREMONE P/OSILO-BATENTE S/MOLETA 873.756 Preto

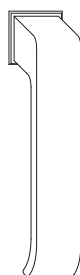

(Utilizar com o cremone 870.752)

211310

MOLETA CREM. 1243.599 Preto

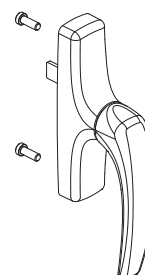

(Para janelas com oscilo-batente)

200466

CREMONE ARIANA 868.2



215114

PEÇA CREMONE VARETA 1481



206475

TERMINAL VARETA C/ REGULAÇÃO 1487



206490

TERMINAL VARETA 1486



206500

TERMINAL VARETA 2000



202090

CONTRA-FECHO DUPLO 1416.6



202077

CONTRA-FECHO 1404

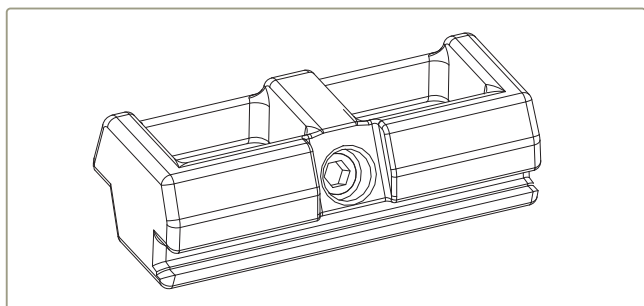

202091

CONTRA-FECHO DUPLO REGULÁVEL 1414

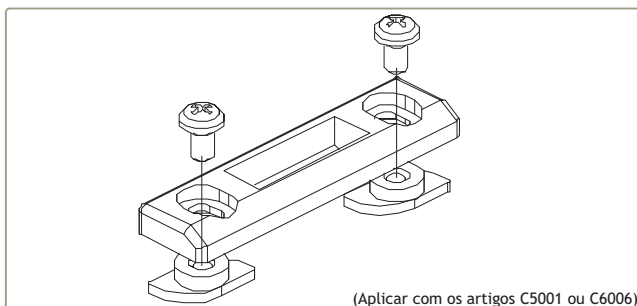

202310

CONTRA-FECHO DUPLO REGULÁVEL 2020

(Aplicar com os artigos C5001 ou C6006)

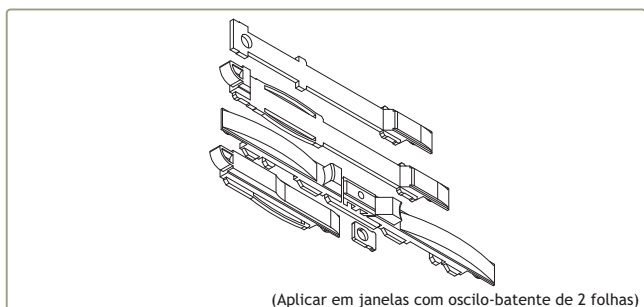

201030

FECHO SEMI-AUTO PARA 2ª F C/O-B C6006

(Aplicar em janelas com oscilo-batente de 2 folhas)

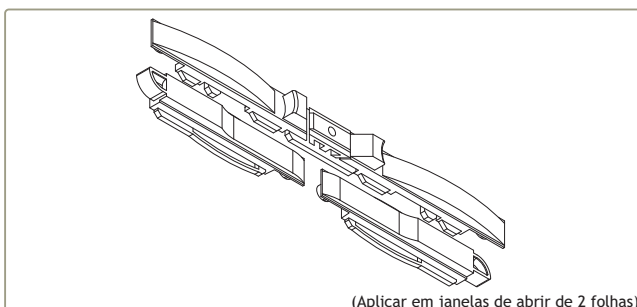

201507

FECHO SEMI-AUTO PARA 2ª FOLHA C5001

(Aplicar em janelas de abrir de 2 folhas)

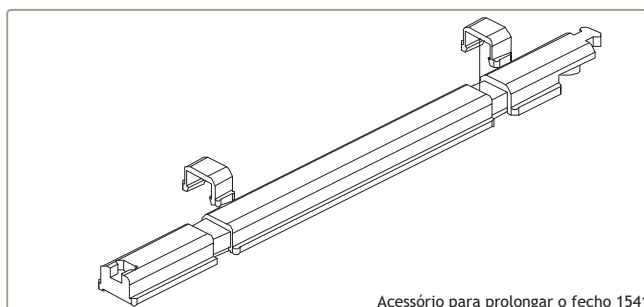

Acessório para prolongar o fecho 1541

401001

ALONGAMENTO 1541.800

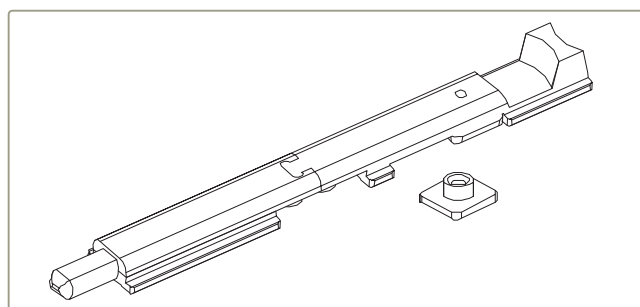

201490

FECHO PARA 2ª FOLHA 1541



(Aplicar em janelas de 2 ou 3 folhas com oscilo-batente)

225130

PASSADOR 3000.854



(Aplicar com o fecho 1541 em vãos de 3 ou 4 folhas ou com oscilo-batente)

214280

VARETA 1541.820



(Para portas de 2, 3 ou 4 folhas)

225155

PASSADOR REVERSÍVEL 1550

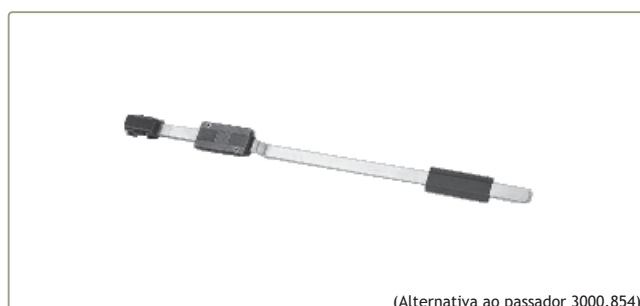

(Alternativa ao passador 3000.854)

225205

FECHO PARA 2ª FOLHA 1545.2



Acessório para prolongar o passador 1550)

221154

HASTE FECHO 1550.801



211103

PONTO FECHO PAVIMENTO 1409/8

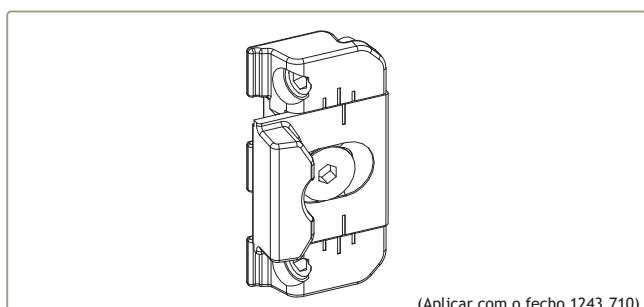

(Aplicar com o fecho 1243.710)

202075

CONTRA-FECHO 1243.721

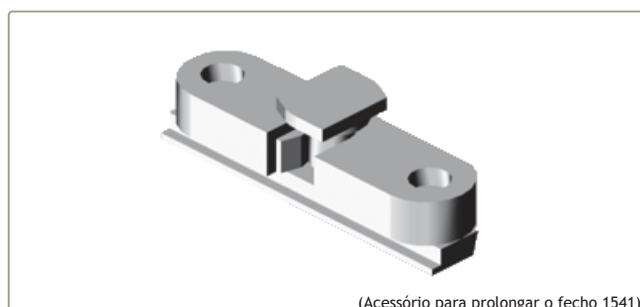

(Acessório para prolongar o fecho 1541)

218206

CLIQUE DE RETENÇÃO 1468

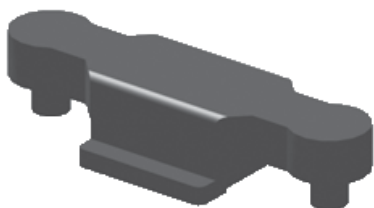

(Para 3º ponto de fecho)

201463

FECHO LATERAL 1243.710

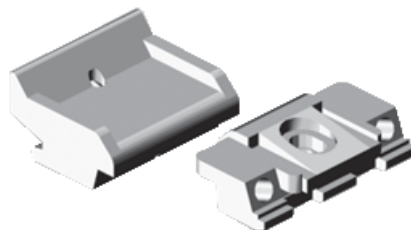

(Para vãos com H>1400mm)

201537

FECHO SUPLEMENTAR 1246.832

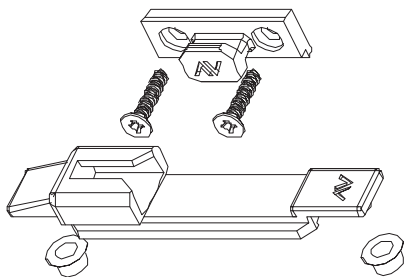

(Pontos de fecho suplementares)

201363

FECHOS ANTI-ARROMBAMENTO 1246.835



(Aplicar com o artigo 1463)

202089

CONTRA-FECHO DUPLO 1416.5

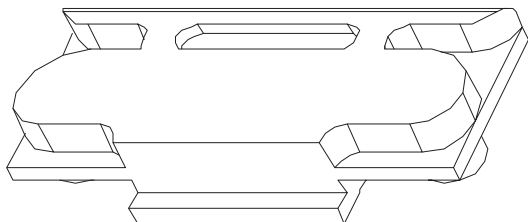

(Aplicar com o artigo 1416.5)

230225

SUPLEMENTO PARA VENTILAÇÃO 1463

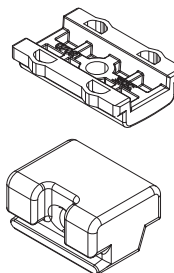

212154

CONJUNTO PARA CALÇO 1410.50 Pr.

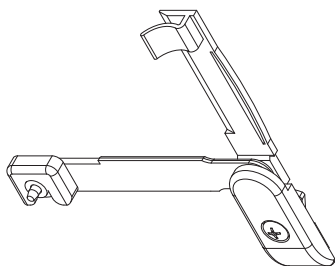

228104

LIMITADOR DE ABERTURA 6060 Pr.



(Chave 874.598 para retirar puxador 874.2. Sob pedido)



(Aplicar com art. 1200/8 ou 1201/8)

200814

PUXADOR SIMPLES 874.2



(Para Puxador 874.2)

207511

TAMPA DE PROTECÇÃO 874.805



201497

FECHO P/BASCULANTE 1370.1

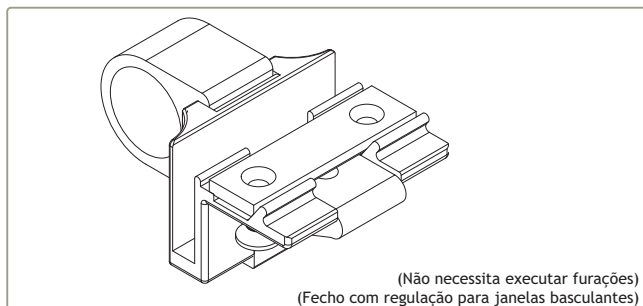

201547 FECHO P/BASCULANTE REGULÁVEL 509R (Br., Pr. ou Cinza)

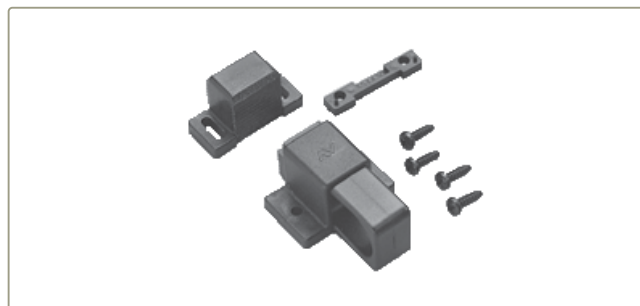

201495 FECHO PARA BASCULANTE 1357



228117 MECANISMO DUO 1201/8



228010 MECANISMO MONO 1200/8



212060 CONJUNTO DOBRADIÇA INOX 1953
(Para janela basculante ou projectante)



210114 BRAÇO PIOVRA 1344.4
210103 BRAÇO PIOVRATRE 1341 (Altura mín. folha = 280mm)



202040 COMPASSO LIMITADOR DE ABERTURA 1343.2



212030 CONJUNTO BRAÇO PARA PROJECTANTES S 150

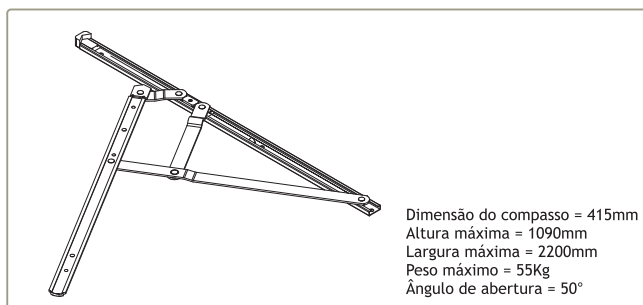

212032 CONJUNTO BRAÇO PROJECTANTE S 400

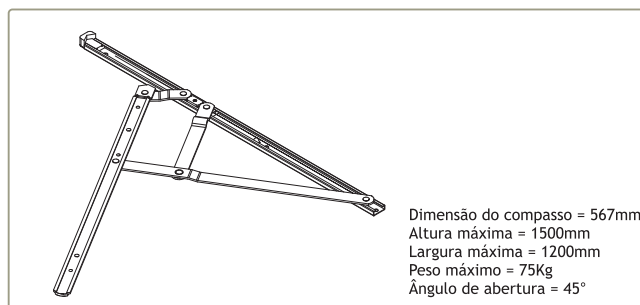

212034 CONJUNTO BRAÇO PROJECTANTE S 550

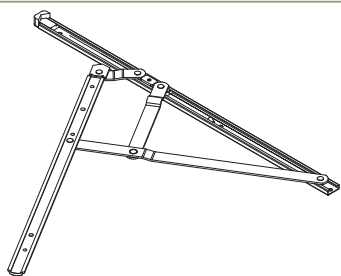

Para vãos até 100Kg
Dimensão do compasso = 685mm
Altura máxima = 2000mm
Altura mínima = 750mm
Largura máxima = 2200mm
Ângulo de abertura = 20°

Para vãos até 120Kg (usar com o KIT ST 7280)
Dimensão do compasso = 720mm
Altura máxima = 2000mm
Altura mínima = 800mm
Largura máxima = 2200mm
Ângulo de abertura = 15°

212021
223007

CONJUNTO BRAÇO PROJECTANTE ST 26
KIT AJUSTÁVEL ST 280



(Para janela projectante com dobradiça)
(Peso máx. com 2 compassos = 70Kg)

202065

COMPASSO SAVIO 1307.1

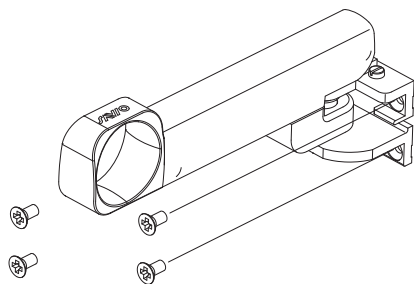

202605
214253

COMANDO 1206.1/2 LAC. 900
COMANDO 1206.1/1 LAC. 905

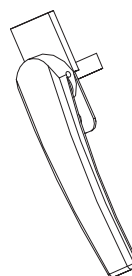

416006

MANÍPULO ARTICULADO BAIXO SOS



(L = 12.8mm)

290101

PARAFUSO PB 12.8 mm



(Aplicar com o Manípulo Articulado Baixo SOS)

228210

MECANISMO INTERIOR SOS



(Aplicar com os cremones 876, 876.751 ou 915.1 e nos cremones 897.2, 897.3 ou 879.751)

223670

KIT MOV. INT. 1475.6



2 Dobradiças = 80 Kg
3 Dobradiças = 90 Kg

202208

DOBRADIÇA MORSA 1121.1



2 Dobradiças = 90 Kg
3 Dobradiças = 100 Kg

202104

DOBRADIÇA MORSA 1122



2 Dobradiças = 80 Kg
3 Dobradiças = 90 Kg

202209

DOBRADIÇA MORSA 1123

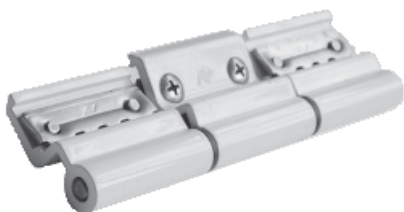

2 Dobradiças = 90 Kg
3 Dobradiças = 100 Kg

202112

DOBRADIÇA MORSA PARA A 3ª FOLHA 1122.92



CONSULTAR DEPARTAMENTO TÉCNICO

202141

DOBRADIÇA AVANÇO PB 2000

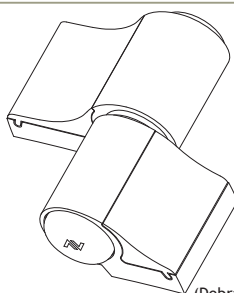

(Dobradiça com regulação nos 3 eixos)
(Dobradiça certificada para peso máx.=150Kg)

202010

DOBRADIÇA MECÂNICA 2 ABAS 1145/60



(Dobradiça oculta)

222121

JOGO DOBRADIÇA 3020

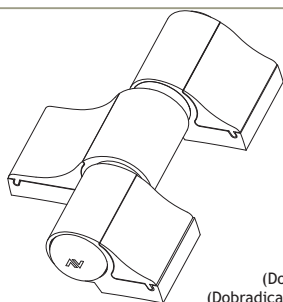

(Dobradiça com regulação nos 3 eixos)
(Dobradiça certificada para peso máx.=180Kg)

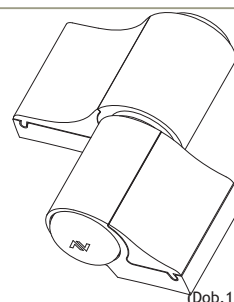
202610
000000DOBRADIÇA MECÂNICA 3 ABAS 1145.3/60
DOBRADIÇA MECÂNICA 3 ABAS 1145.3/79

(Dob. 1145.3/79 certificada para peso máx.=180Kg)

202012

DOBRADIÇA MECÂNICA 2 ABAS 1145/79

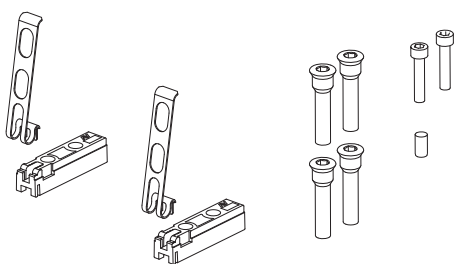

(Kit para dobradiça 1145/60)

223100

KIT DE FIXAÇÃO PARA MECÂNICA 1145.705

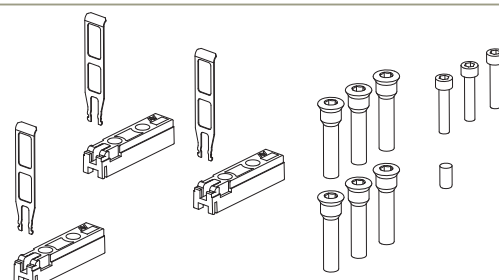

(Kit para dobradiça 1145.3/60)

223020

KIT DE FIXAÇÃO PARA MECÂNICA 1145.715

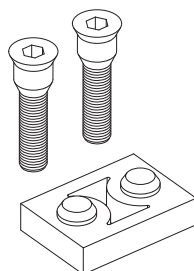

(Dobradiça 1145/60 = 1 Calço)
(Dobradiça 1145.3/60 = 2 Calços)

218170

CALÇO PARA DOBRADIÇA MECÂNICA 1145.703/7



(1145.801: aplicar com as dobradiças 1145/79 ou 1145.3/79)
(1145.802: aplicar com as dobradiças Mecânica - abertura para exterior)

210011

SEPARADOR 1145.802



(Gabarito para executar a furação para aplicação das dobradiças Mechanica)
(Utilizar o Gabarito 1145.905 para afinação das dobradiças)

GABARITO MONTAGEM 1125.951 AC. Nt.



(1125.802: aplicar com as dobradiças 1127, 1127.1 ou 1129, com abertura para exterior)

210010

SEPARADOR 1125.802



(Gabarito para executar a furação para aplicação das dobradiças Mechanica)

211101



(Gabarito de afinação 1145.905 para as dobradiças Mechanica)

GABARITO PARA FURAÇÃO 1145.908



(Aplicar com a Tampa 1129.802 em conjunto com Dobradiça 1127 ou 1127.1)

202511

DOBRADIÇA P/ MOLA 1147

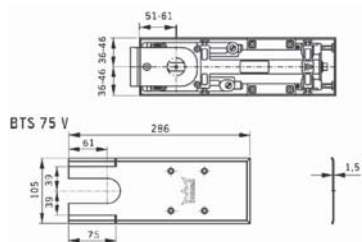

BTS 75 V

(Mola de Pavimento para batente e vai-vem)
(Peso: 120Kg/folha)

228071

MOLA DE PAVIMENTO BTS 75V



* 1132.1/60 (Mesmo plano)
* 1132.1/60 + Calço 1145.703/7 (Plano diferente)

202510

DOBRADIÇA 2 ABAS 1132.1/60

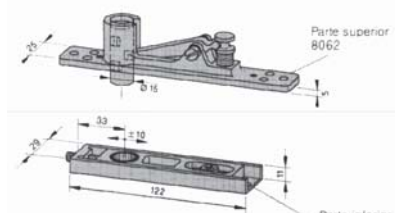

(Aplicar com a Mola de Pavimento BTS 75V)

227111

PIVOT SUPERIOR VAI-DEM 8062

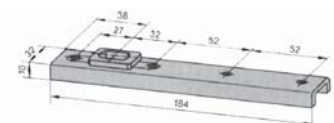

(Aplicar com a Mola de Pavimento BTS 75V)
Para pesos de porta até 100Kg

210104

BRAÇO INFERIOR VAI-DEM 8021

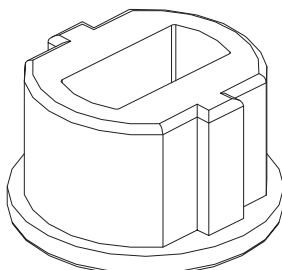

(Para Mola Pav. BTS 75V - batente - com utilização da dobradiça 1147)

207327

SEPARADOR R. TER/1129.802 OXID

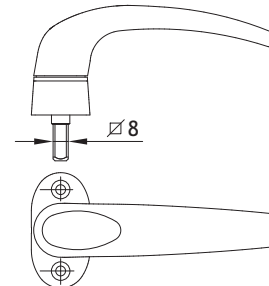

200814

PUXADOR SIMPLES 874.2

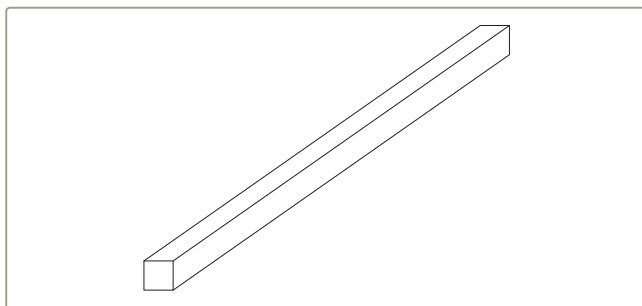

227301

QUADRA AÇO 8mm PARA PUXADOR 874.31

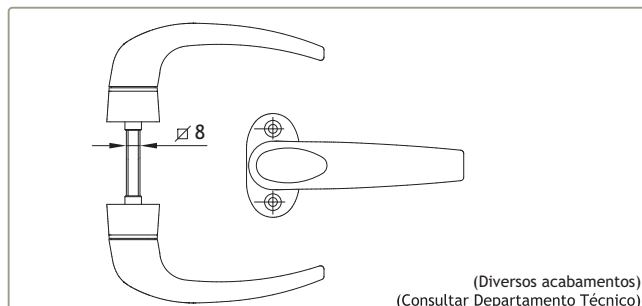

200747

PUXADOR DUPLO 874.31

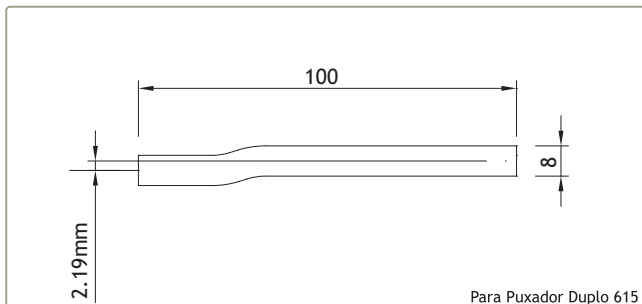

227302

QUADRA DESCENTRADA 130mm



200920

PUXADOR DUPLO 615

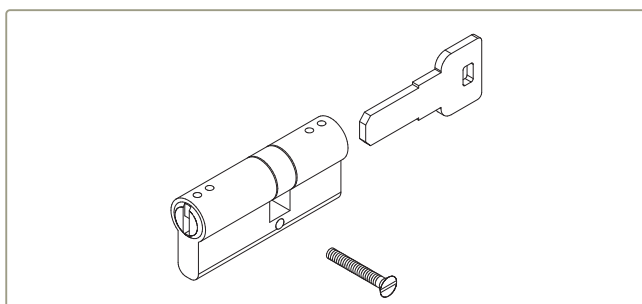

207403

CILINDRO SEGURANÇA 60/30

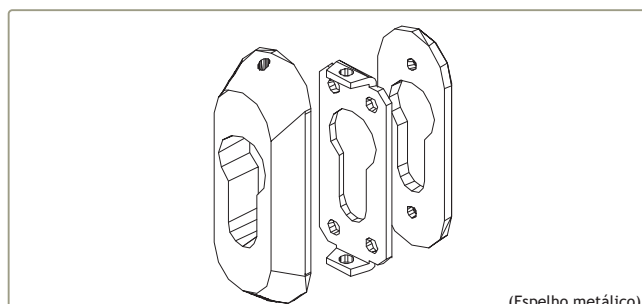

220008

ESPELHO PARA SEGURANÇA 5100 (Pr.)

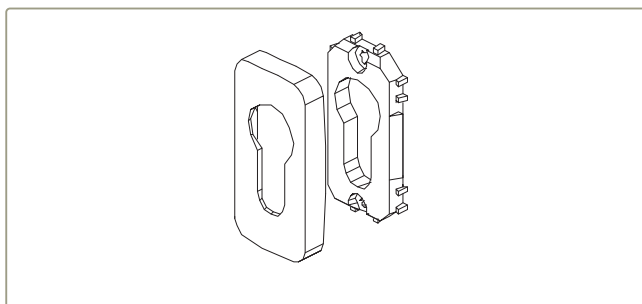

220190

ESPELHO 874.801 (Br./Pr.)



280200

TESTA FECHADURA 5791x90

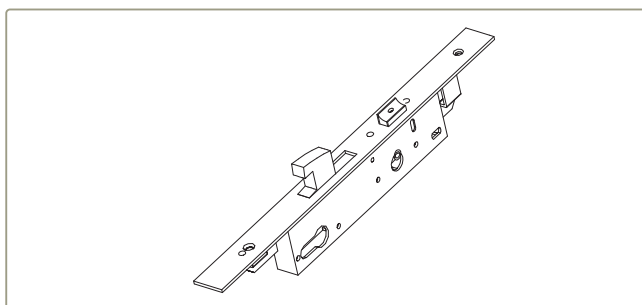
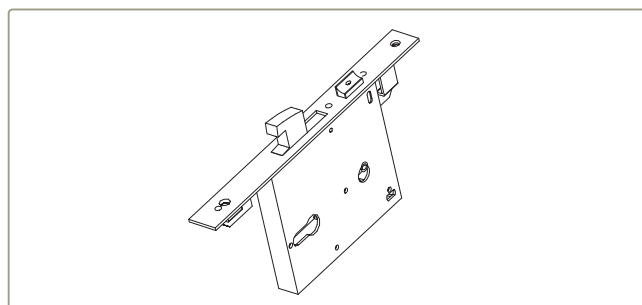
201033
201034FECHADURA 7797x30
FECHADURA 7797x35

201013

FECHADURA DE ALMOFADA 5791x90

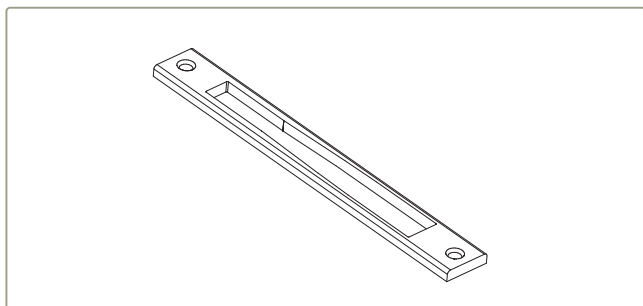

280230

TESTA FECHADURA STAND 2001

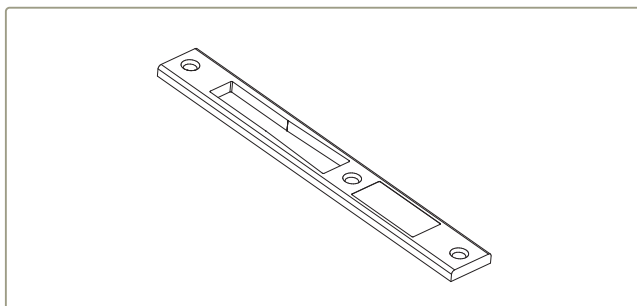

280220

TESTA FECHADURA PRUMO 2000

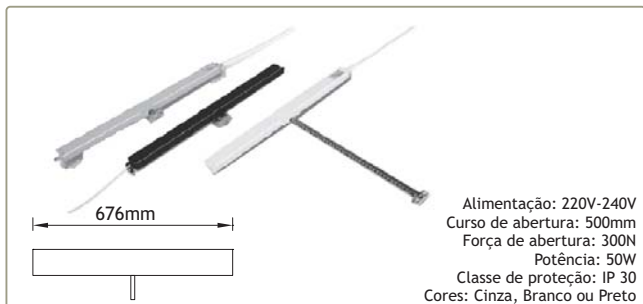

212640

ACIONADOR 40837Z

Alimentação: 220V-240V
Curso de abertura: 500mm
Força de abertura: 300N
Potência: 50W
Classe de proteção: IP 30
Cores: Cinza, Branco ou Preto

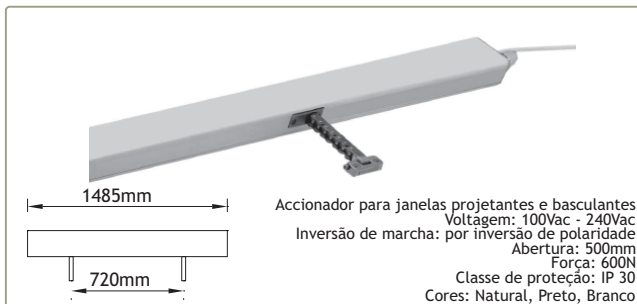

212036

ACIONADOR ELÉCTRICO DUPLO 240Vac 40989D(Nat.)

Accionador para janelas projetantes e basculantes
Voltagem: 100Vac - 240Vac
Inversão de marcha: por inversão de polaridade
Abertura: 500mm
Força: 600N
Classe de proteção: IP 30
Cores: Natural, Preto, Branco



230018

SUPORTE PARA MOTOR 40858U

Cores: Natural, Preto, Branco



230463

SUPORTE PARA ACION. ELÉC. DUPLO 41101H(Nat.)

Cores: Natural, Preto, Branco

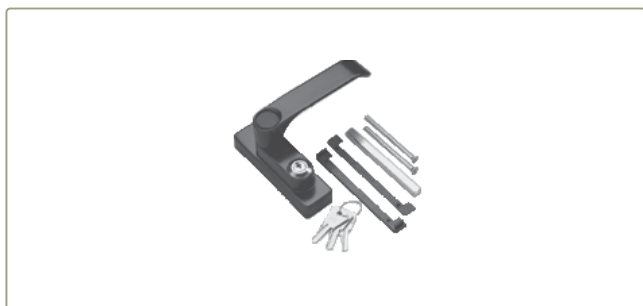

200230

CREMONE COM FECHADURA KH.B.PR.

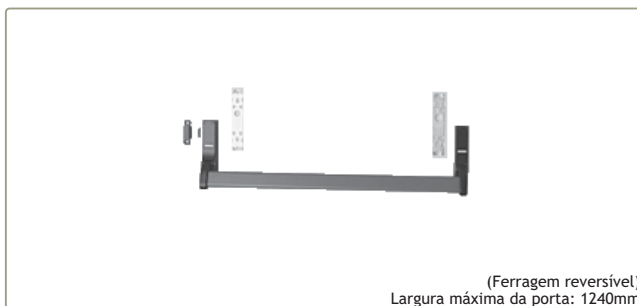

200001

ANTI-PÂNICO HORIZONTAL KH

(Ferragem reversível)
Largura máxima da porta: 1240mm

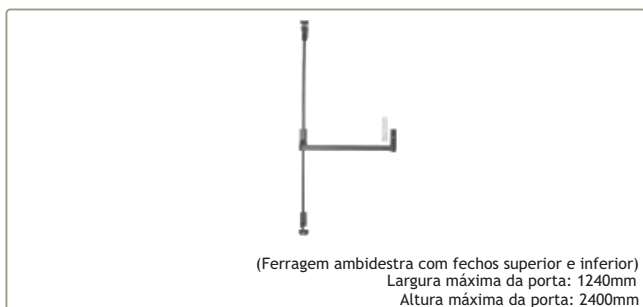

200004

ANTI-PÂNICO VERTICAL KH.2

(Ferragem ambidestra com fechos superior e inferior)
Largura máxima da porta: 1240mm
Altura máxima da porta: 2400mm

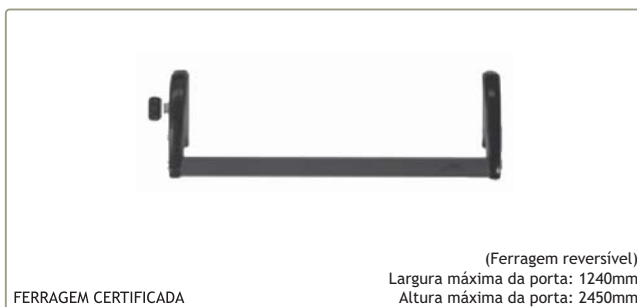

200912

ANTI-PÂNICO HORIZONTAL 6000.1/1200

FERRAGEM CERTIFICADA

(Ferragem reversível)
Largura máxima da porta: 1240mm
Altura máxima da porta: 2450mm



(Ferragem ambidestra com ponto de fecho superior e inferior)
Largura da porta: entre 800mm e 1240mm
Altura máxima da porta: 2450mm

FERRAGEM CERTIFICADA

200968

ANTI-PÂNICO VERTICAL 6000.2/1200



(Ferragem ambidestra com ponto de fecho superior e inferior)
Largura da porta: entre 800mm e 1240mm
Altura máxima da porta: 2450mm

FERRAGEM CERTIFICADA

000000

ANTI-PÂNICO VERTICAL 6100.2/1085



(Ferragem ambidestra com 3 pontos de fecho superior e inferior e lateral)
Largura da porta: entre 800mm e 1240mm
Altura máxima da porta: 2450mm

200988

ANTI-PÂNICO VERTICAL 6000.3/1200



(Ferragem ambidestra com 3 pontos de fecho superior e inferior e lateral)
Largura da porta: entre 800mm e 1240mm
Altura máxima da porta: 2450mm

200971

ANTI-PÂNICO VERTICAL 6100.3/1085



(Ferragem reversível)
Largura da porta: entre 800mm e 1240mm
Altura máxima da porta: 2450mm

FERRAGEM CERTIFICADA

200970

ANTI-PÂNICO HORIZONTAL 6100.1/1085



200914

CREMONE COM FECHADURA 6000.875. Pr.

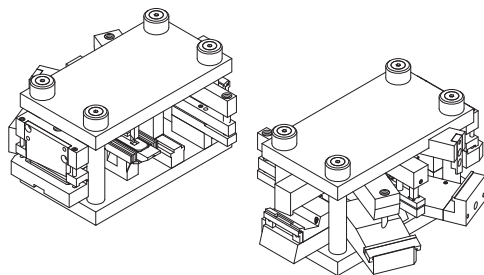

408044

CORTANTE SISTEMA IT/ST



426003

TESOURA PARA VEDANTES MULTICOUP

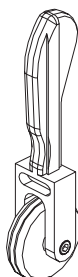

425001

ROLETA P/VED. CPT 150D

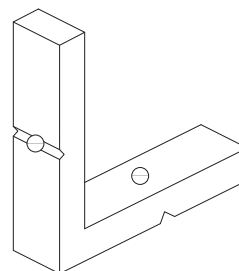

(Para os perfis KY 84 e KY 86)

204380

ESQUADRO 1108

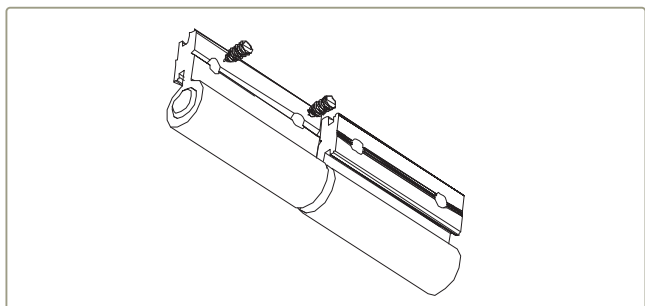

202230

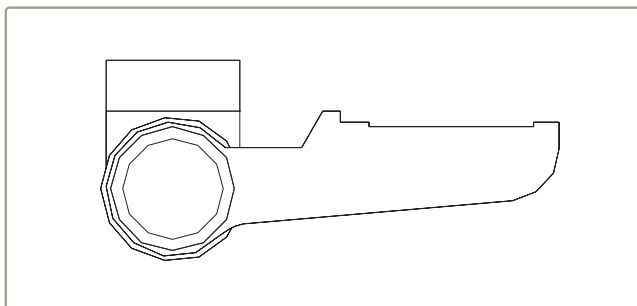
DOBRADIÇA PARA PORTADAS
INTERIORES / REDE MOSQUITEIRA

202229

DOBRADIÇA PARA SISTEMA TAPA-LUZ

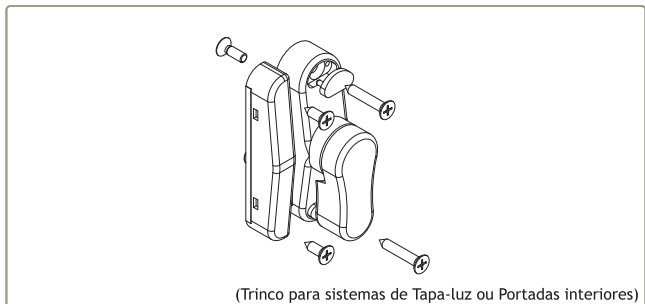

231214

TRINCO REVERSÍVEL 9566 (Br. / Pr.)

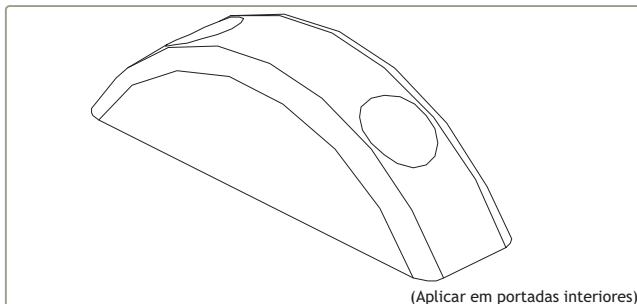

214146

BATENTE PARA PERSIANA 877.804

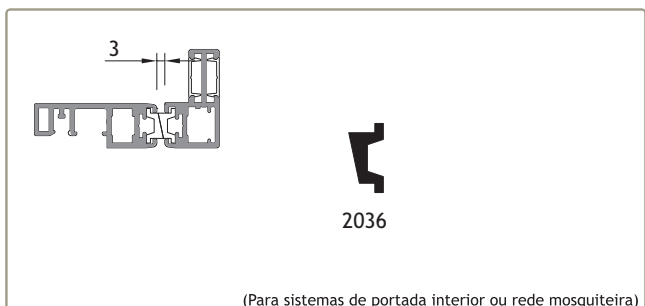

215155

PERFIL MAGNÉTICO 2036

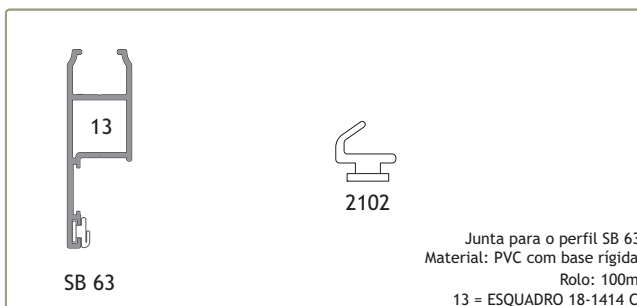

208264

JUNTA ESTANQUICIDADE 2102

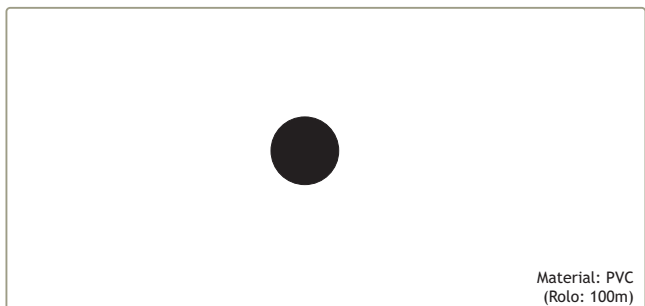

208310

VEDANTE PARA MOSQUITEIRA 1027 Pr.

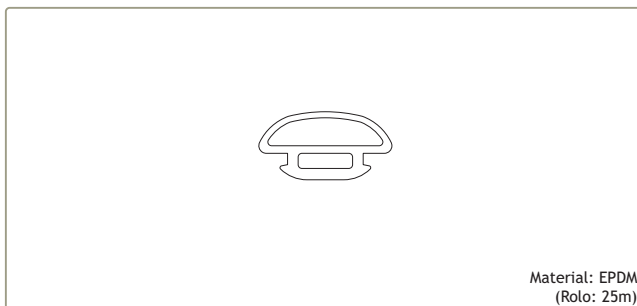
Material: PVC
(Rolo: 100m)

208261

VEDANTE PARA MOSQUITEIRA 2027 Pr.

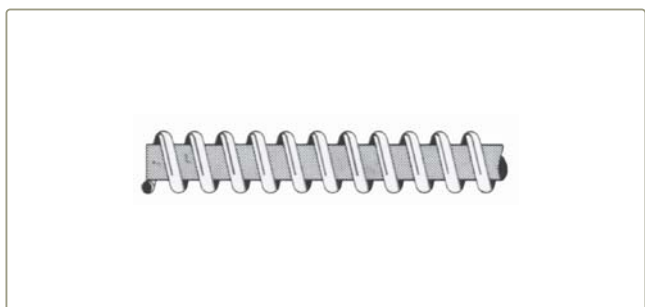
Material: EPDM
(Rolo: 25m)

217118

BICHA F604 (POR METRO)



231002

TUBO F111 (3 METROS)

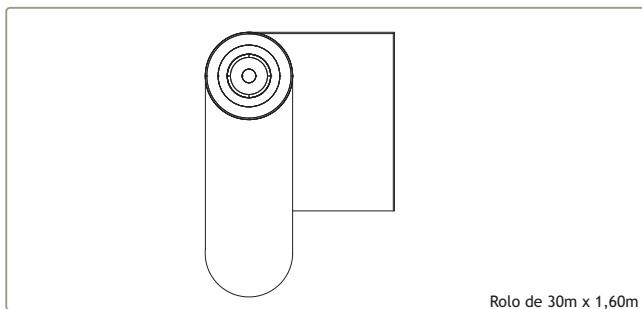

Rolo de 30m x 1,60m

229105

REDE MOSQUITEIRA EM FIBRA



(Puxador para sistema de rede mosquiteira)

200910

PUXADOR SIMPLES SOS



(Sem Bicha e sem Tubo)

223760

KIT PARA BASCULANTE SIMPLES

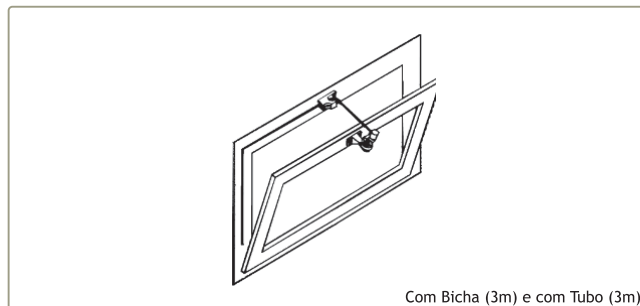

Com Bicha (3m) e com Tubo (3m)

223906

KIT COMPLETO QL. 1 (3m)



213124

ACIONADOR MECÂNICO CINZA

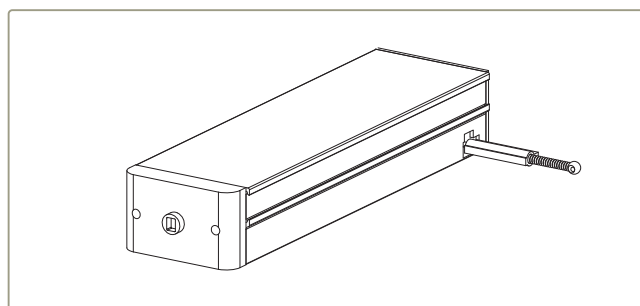

212248

ACIONADOR ELÉTRICO PRT.



220100

DISPOSITIVO MANUAL P18/14

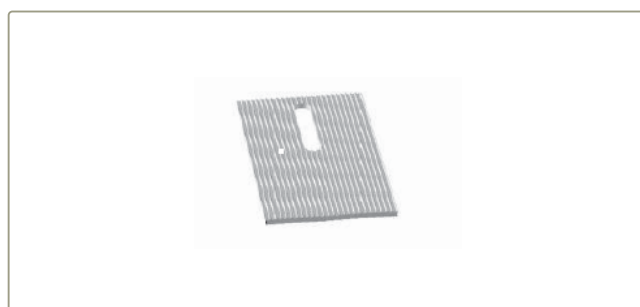

218116

CALÇO SEPARADOR (50 x 70mm)



207220

PRESILHA M6 x 37mm



207203

PRESILHA M6 x 17mm



213239
213240

ÂNGULO DE FIXAÇÃO 100mm
ÂNGULO DE FIXAÇÃO 120mm



230014
230019

SUPORTE DE FIXAÇÃO 100mm
SUPORTE DE FIXAÇÃO 120mm

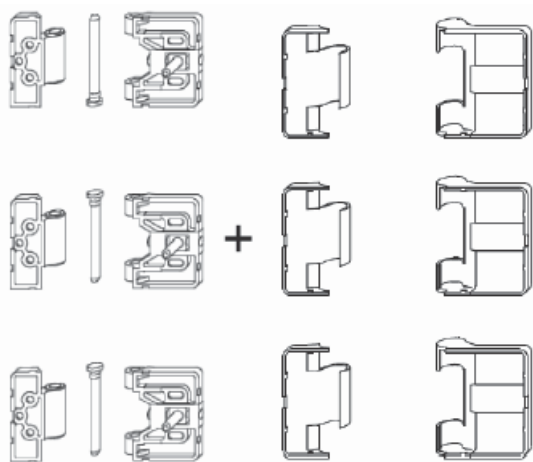

Dobradiças

Coberturas

212064
212879
212878

CONJUNTO DOBRADIÇAS FS-LM BRUTO
CONJUNTO COBERTURAS P/DOBRADIÇAS FS-LM BRC
CONJUNTO COBERTURAS P/DOBRADIÇAS FS-LM PRT

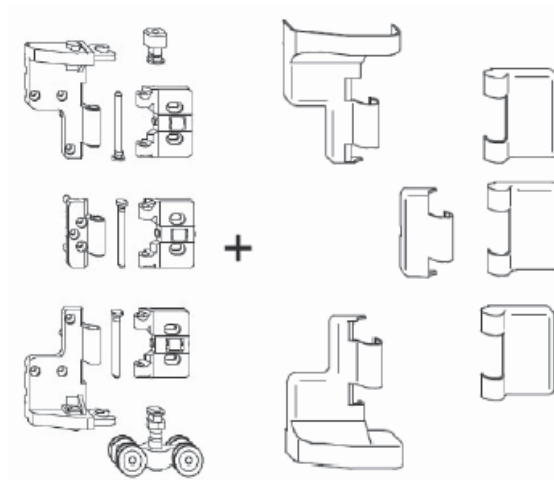

Rolamento

Coberturas

212321
212880
212877

CONJUNTO ROLAM. INTERM. FS-LM BRUTO
CONJUNTO COBERTURA P/ROLAM.INTERM. FS-LM BRC
CONJUNTO COBERTURAS P/ROLAM. INTERM. FS-LM PRT

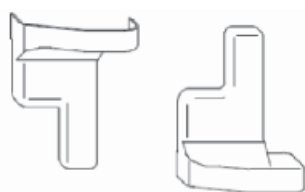

Coberturas

+

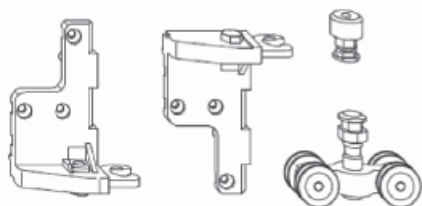

Rolamento

212320
212881

CONJUNTO ROLAM. TERM. FS-LM BRUTO
CONJUNTO COBERTURA P/ROLAM. TERM. FS-LM BRC/PRT



Limpeza de alumínio lacado ou anodizado
Para preparação das zonas a serem unidas e limpeza final

208704

PRODUTO DE LIMPEZA DE ALUMÍNIO (1L) Transparente



Junta de vedação elástica, resistente aos UV
Impede a corrosão de penetrar pelas zonas cortadas

208019

SELA JUNTAS 150gr. (Cinza)

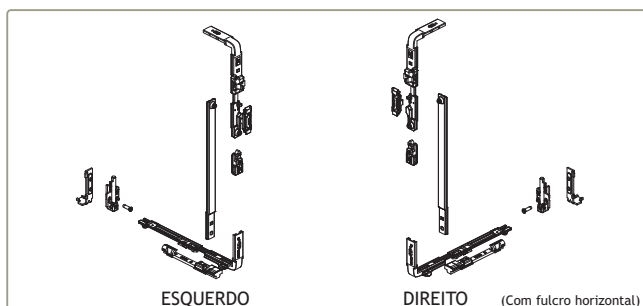

299036
299037

CARTÃO BASE 3200.2L RB5 ESQUERDO
CARTÃO BASE 3200.2R RB5 DIREITO

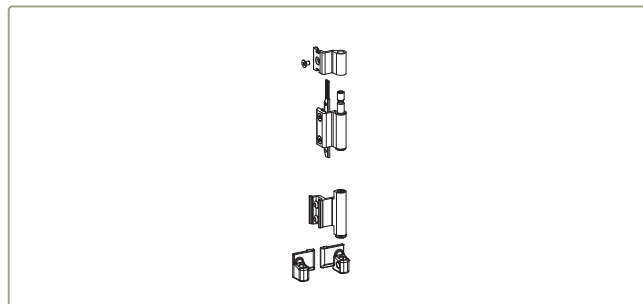

222123

JOGO DOBRADIÇAS 3200.709 RB5 110Kg

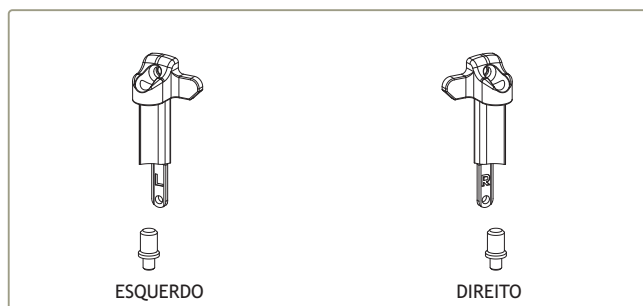

299038
299039

REFORÇO DE DOBRADIÇA PARA 140Kg 3200.708L RB5 ESQ.
REFORÇO DE DOBRADIÇA PARA 140Kg 3200.708R RB5 DIR.

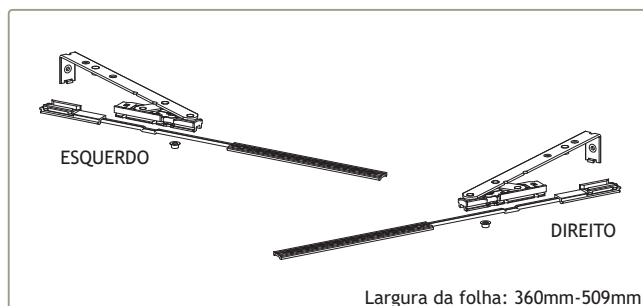

202043
202044

COMPASSO CURTO 3200-750L RB5 ESQ.
COMPASSO CURTO 3200-750R RB5 DIR.

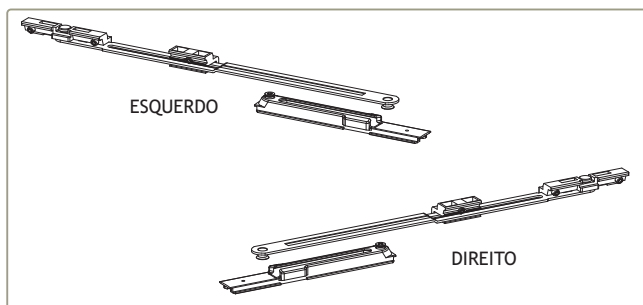

202047
202048

COMPASSO SUPLEMENTAR 3200.800L HORIZ. RB5 ESQ.
COMPASSO SUPLEMENTAR 3200.800R HORIZ. RB5 DIR.

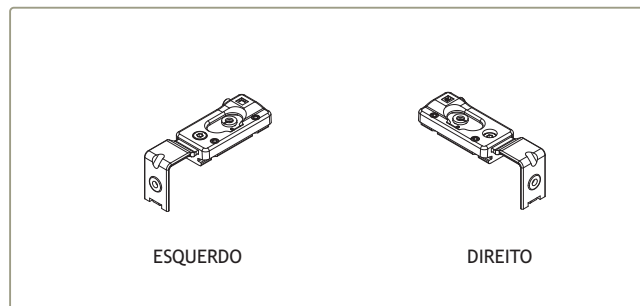

230310
230311

SUPORTE SUPERIOR DE DOBRADIÇAS 3200.840L RB5 ESQ.
SUPORTE SUPERIOR DE DOBRADIÇAS 3200.840R RB5 DIR.

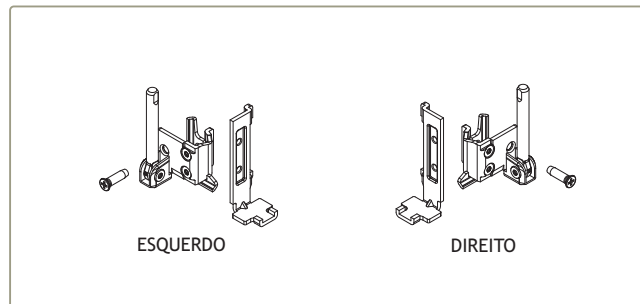

230312
230313

SUPORTE INFERIOR DE DOBRADIÇAS 3200.710L RB5 ESQ.
SUPORTE INFERIOR DE DOBRADIÇAS 3200.710LR RB5 DIR.

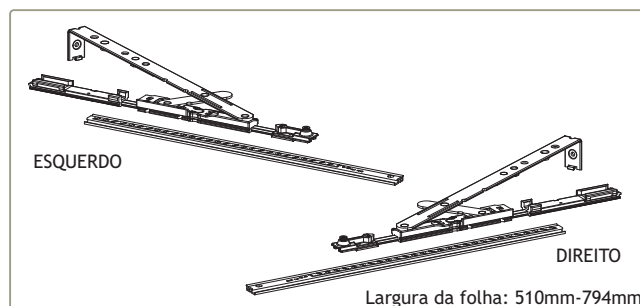

202041
202042

COMPASSO STANDARD 3200.751L RB5 ESQ.
COMPASSO STANDARD 3200.751R RB5 DIR.

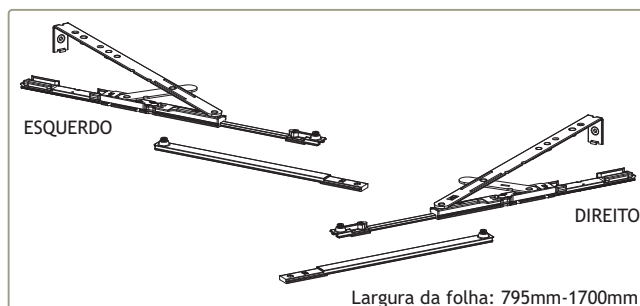

202045
202046

COMPASSO GRANDE 3200-752L RB5 ESQ.
COMPASSO GRANDE 3200-752R RB5 DIR.

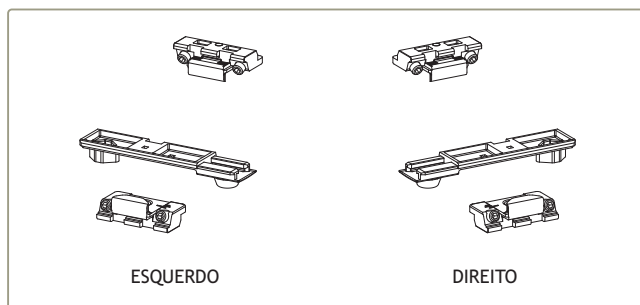

211022
211023

PONTOS DE FECHO EXTRA 3200.825L HORIZ. RB5 ESQ.
PONTOS DE FECHO EXTRA 3200.825R HORIZ. RB5 DIR.

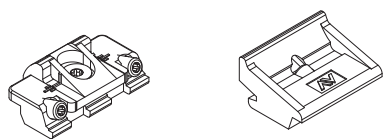

201044

FECHO SUPLEMENTAR 1246.832W RB5

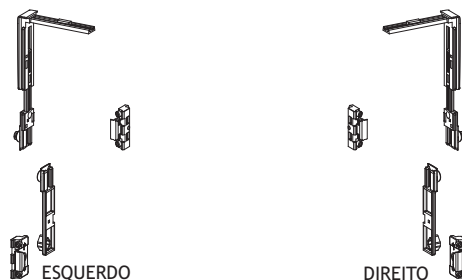
211024
211025PONTOS DE FECHO EXTRA 3200.820L VERT. RB5 ESQ.
PONTOS DE FECHO EXTRA 3200.820R VERT. RB5 DIR.

211026

PONTO DE FECHO SUPLEMENTAR FIXO 1243.721W RB5

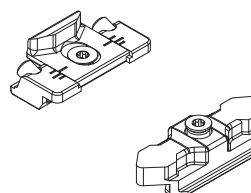

211027

PONTO DE FECHO SUPLEMENTAR FIXO/MÓVEL 3200.810 RB5



225168

PASSADOR COM PONTEIRA INOX 3200.851 RB5

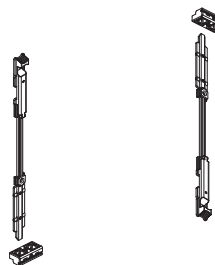

212091

CONJ. FECHOS PASSADOR 2ª FOLHA Inox F3200.851.92 RB5

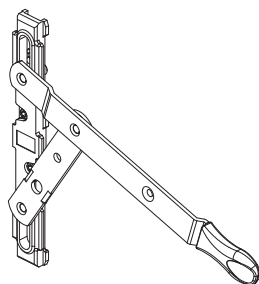

225169

PASSADOR DE ALAVANCA BIDIRECIONAL 1538 RB5

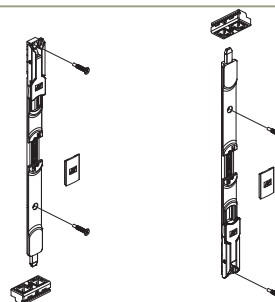

212095

CONJUNTO FECHOS DE ALAVANCA 2ª FOLHA F1539 RB5

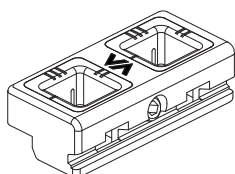

202316

CONTRA-FECHO DUPLO REG. 1414W RB5



212139

CONJ. FECHO ALAV. BIDIRECIONAL 2ª FOLHA Inox F1538.4 RB5

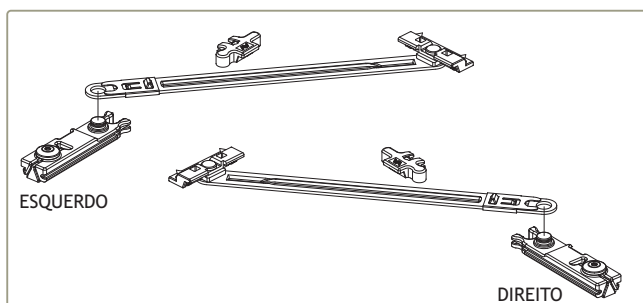

202049 COMP. LIMITADOR C/RETENÇÃO 200mm 1343.8L /20 RB5 ESQ.
202055 COMP. LIMITADOR C/RETENÇÃO 200mm 1343.8R /20 RB5 DIR.

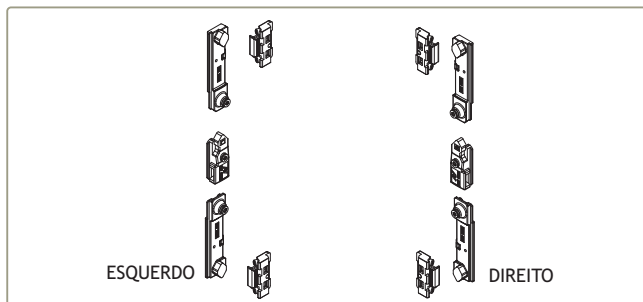

223021 KIT 1 FOLHA BATENTE 3200.600L RB5 ESQ.
223022 KIT 1 FOLHA BATENTE 3200.600R RB5 DIR.

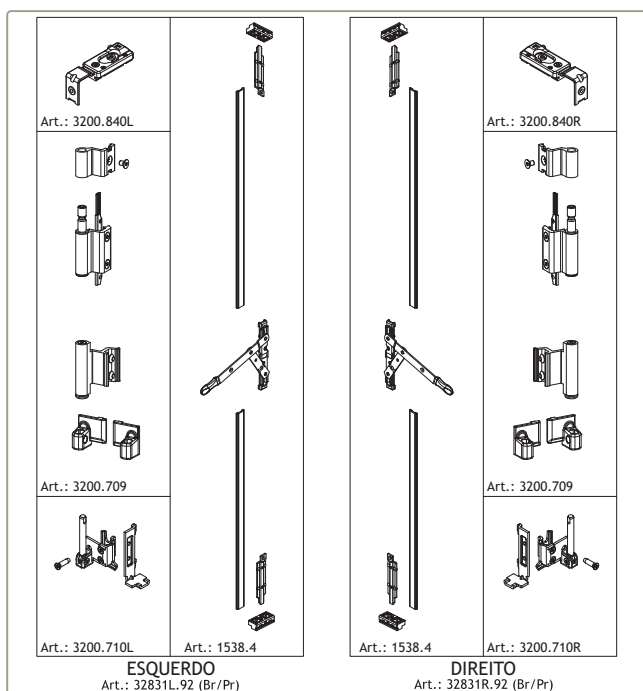

223025 KIT 2ª FOLHA BIDIRECIONAL F32831L.92 RB5 ESQ.
223026 KIT 2ª FOLHA BIDIRECIONAL F32831R.92 RB5 DIR.

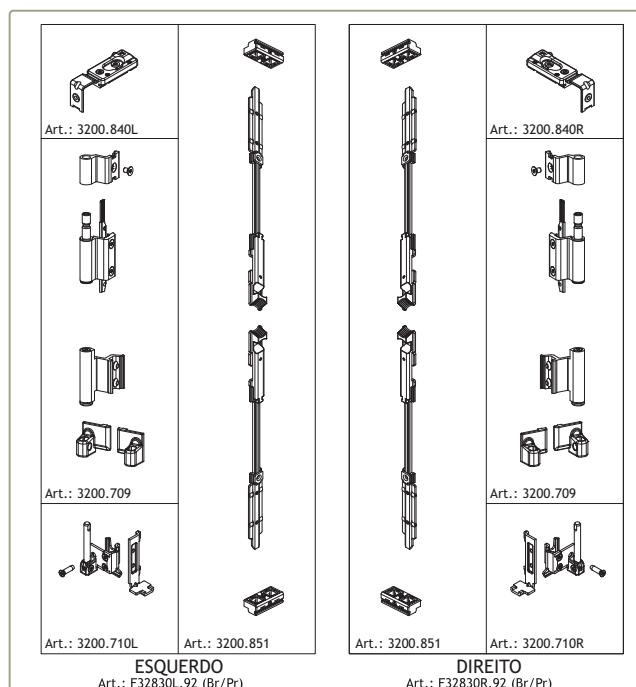

223023 KIT 2ª FOLHA F32830L.92 RB5 ESQ.
223024 KIT 2ª FOLHA F32830R.92 RB5 DIR.

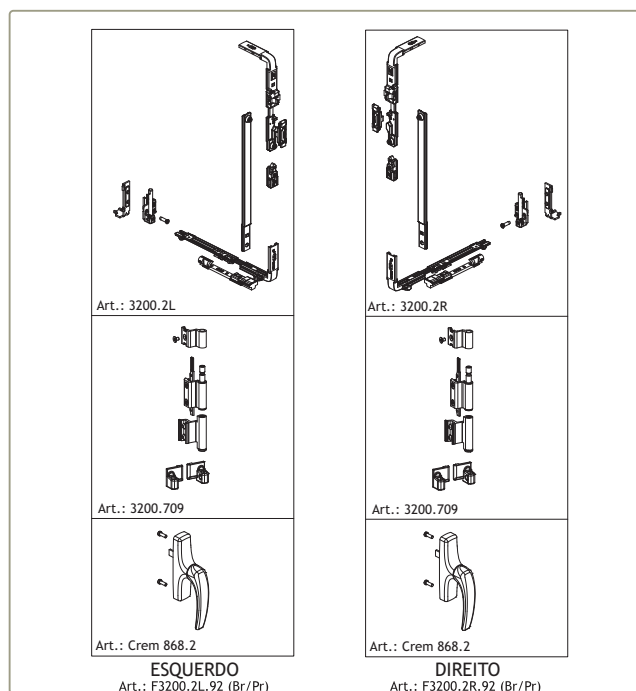

223027 KIT OSCILO-BAT 1 FOLHA S/COMPASSO F3200.2L.92 RB5 ESQ.
223028 KIT OSCILO-BAT 1 FOLHA S/COMPASSO F3200.2R.92 RB5 DIR.





Pormenores de montagem

Assembly details
Détails d'assemblage





JANELA DE BATENTE DE 1 FOLHA - LINHA RETA

1 LEAF CASEMENT WINDOW - STRAIGHT LINE

FENÊTRE À LA FRANÇAISE 1 VANTAIL - LIGNE DROITE

PERFIS PROFILES PROFILS				
REFERÊNCIA REFERENCE RÉFÉRENCE	CORTE HORIZONTAL HORIZONTAL DETAIL DÉTAIL HORIZONTAL	CORTE VERTICAL VERTICAL DETAIL DÉTAIL VERTICALE	QUANTIDADE QUANTITY QUANTITÉ	CORTE CUT COUPÉ
IT-01	L-6	H-6	2+2	
IT-02	L-48	H-48	2+2	
-	L-136	H-176	2+2	
SA-33	-----	(H-290)/2	2	

ACESSÓRIOS ACCESSORIES ACCESSOIRES		
CÓDIGO CODE	DESIGNAÇÃO DESIGNATION DÉSIGNATION	QUANTIDADE QUANTITY QUANTITÉ
210154	GOTEIRA 1875 DRIP GOUTTIÈRE	2
213261	CANTO ALINHAMENTO S IT/ST ALIGNMENT CORNER COIN ALIGNEMENT	4
213308	CANTO CR 0018 ANGLE COIN	4
204150	ESQUADRO 18-0512-C BLOCKING BRACKET ÉQUERRE	4
204142	ESQUADRO IT/ST Nº5 18-2512-140 BLOCKING BRACKET ÉQUERRE	4
204137	ESQUADRO IT/ST Nº1 16-1914-C BLOCKING BRACKET ÉQUERRE	4
202208	DOBRADIÇA 1121.1 HINGE PAUMELLE	2
200302	CREMONE 870.2 HANDLE POIGNÉE	1
215114	PEÇA CREMONE VARETA 1481 OPERATING ROD PIECE ENTRAÎNEUR	2
206490	TERMINAL VARETA 1486 LOCKING TERMINAL TERMINAISON DE FERMETURE	2
202090	CONTRA-FEC. DUPLO 1416.6 DOUBLE COUNTER-LOCK CONTRE-FERM. DOUBLE	2
218194	CALÇOS P/VIDROS EURO 2000 GLAZING SHIM CALE POUR VITRAGE	4

VEDANTES SEALANTS JOINTS		
CÓDIGO CODE	DESIGNAÇÃO DESIGNATION DÉSIGNATION	QUANTIDADE QUANTITY QUANTITÉ
208145	VD 2079	2L+2H
208008	VD 2051 (1)	2L+2H
208184	VD 2412 (opcional optional optionnel)	2L+2H
208186	VD 2105 (2)	2L+2H
208350	VD 2003	2L+2H
VARIÁVEL VARIABLE	JUNTA INTERIOR GLAZING WEDGE GASKET JOINT INTÉRIEUR	2L+4H
213290	CANTO VULCANIZADO 2105.1 CORNER JOINT JOINT VULCANISÉ	4

(1) 208143 VD 2071 (alternativa ao VD 2051 | alternative | alternative)
(2) 208144 VD 2305 (alternativa ao VD 2105 | alternative | alternative)

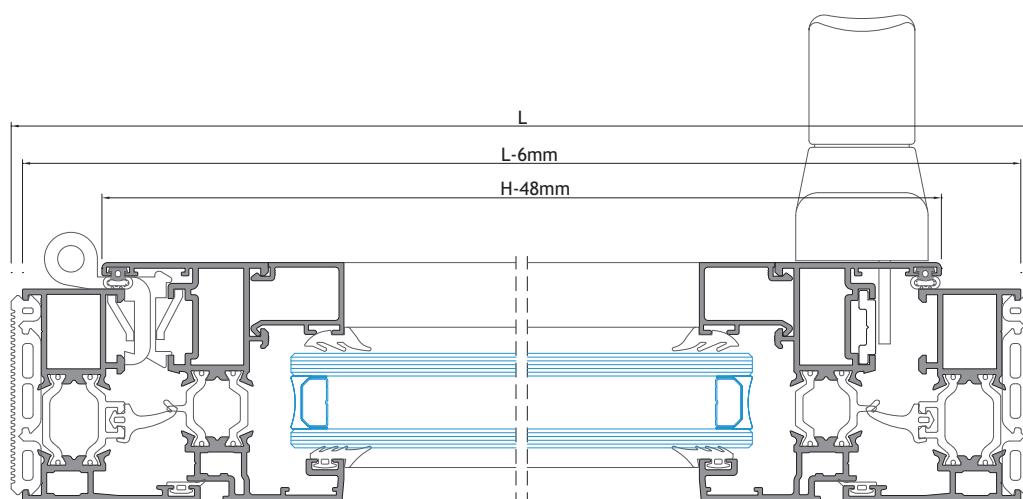
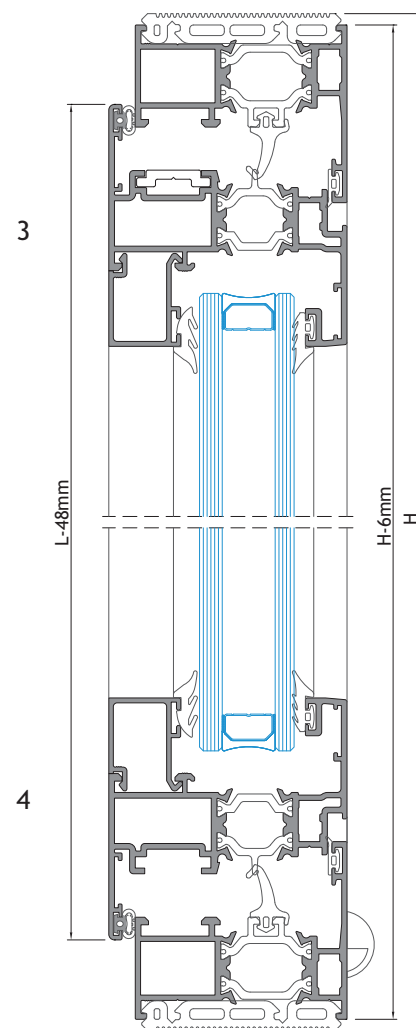
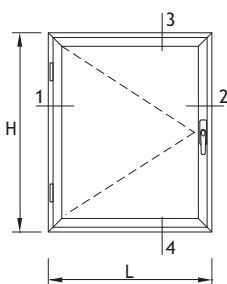

ESC: 1/2

JANELA DE BATENTE 2 FOLHAS - LINHA RETA

2 LEAVES CASEMENT WINDOW - STRAIGHT LINE

FENÊTRE À LA FRANÇAISE 2 VANTAUX - LIGNE DROITE

PERFIS PROFILES PROFILS				
REFERÊNCIA REFERENCE RÉFÉRENCE	CORTE HORIZONTAL HORIZONTAL DETAIL DÉTAIL HORIZONTAL	CORTE VERTICAL VERTICAL DETAIL DÉTAIL VERTICALE	QUANTIDADE QUANTITY QUANTITÉ	CORTE CUT COUPÉ
IT-01	L-6	H-6	2+2	
IT-02	(L-55)/2	H-48	4+4	
IT-06	-----	H-118	1	
-	(L-231)/2	H-176	4+4	
SA-33	-----	(H-290)/2	2	

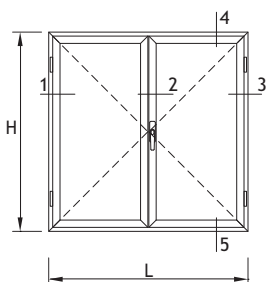

ACESSÓRIOS ACCESSORIES ACCESSOIRES		
CÓDIGO CODE	DESIGNAÇÃO DESIGNATION DÉSIGNATION	QUANTIDADE QUANTITY QUANTITÉ
210154	GOTEIRA 1875 DRIP GOUTTIÈRE	2
213261	CANTO ALINHAMENTO S IT/ST ALIGNMENT CORNER COIN ALIGNEMENT	8
213308	CANTO CR 0018 ANGLE COIN	4
204150	ESQUADRO 18-0512-C BLOCKING BRACKET ÉQUERRE	8
204142	ESQUADRO IT/ST Nº5 18-2512-140 BLOCKING BRACKET ÉQUERRE	8
204137	ESQUADRO IT/ST Nº1 16-1914-C BLOCKING BRACKET ÉQUERRE	4
202208	DOBRADIÇA 1121.1 HINGE PAUMELLE	4
200302	CREMONE 870.2 HANDLE POIGNÉE	1
215114	PEÇA CREMONE VARETA 1481 OPERATING ROD PIECE ENTRÂINEUR	2
206490	TERMINAL VARETA 1486 LOCKING TERMINAL TERMINAISON DE FERMETURE	2
202090	CONTRA-FEC. DUPLO 1416.6 DOUBLE COUNTER-LOCK CONTRE-FERM. DOUBLE	2
218194	CALÇOS P/VIDRO EURO2000 GLAZING SHIM CALE POUR VITRAGE	8
212063	CONJ.TOPO INVERSOR IT END CAP KIT KIT EMBOUTS	1
201490	FECHO P/2ªFOLHA 1541 2ND LEAF LOCKER FERMETURE POUR 2ÈME VANTAIL	2

VEDANTES SEALANTS JOINTS		
CÓDIGO CODE	DESIGNAÇÃO DESIGNATION DÉSIGNATION	QUANTIDADE QUANTITY QUANTITÉ
208145	VD 2079	2L+2H
208008	VD 2051 (1)	2L+3H
208184	VD 2412 (opcional optional optionnel)	2L+3H
208186	VD 2105 (2)	2L+3H
208350	VD 2003	2L+4H
VARIÁVEL VARIABLE	JUNTA INTERIOR GLAZING WEDGE GASKET JOINT INTÉRIEUR	2L+4H
213290	CANTO VULCANIZADO 2105.1 CORNER JOINT JOINT VULCANISÉ	4

(1) 208143 VD 2071 (alternativa ao VD 2051 | alternative | alternative)
(2) 208144 VD 2305 (alternativa ao VD 2105 | alternative | alternative)

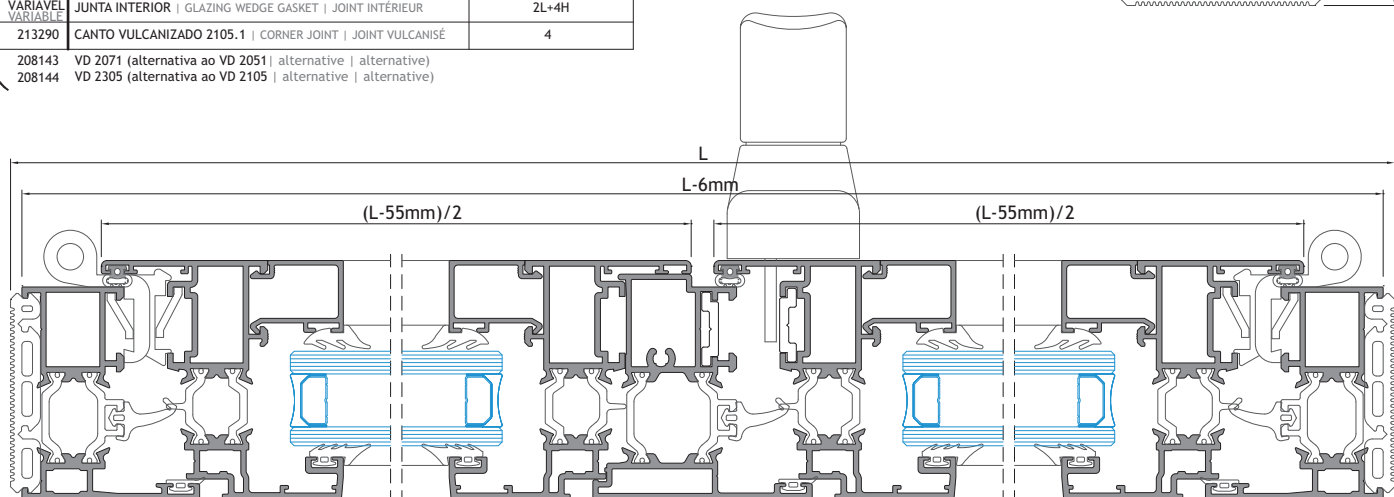
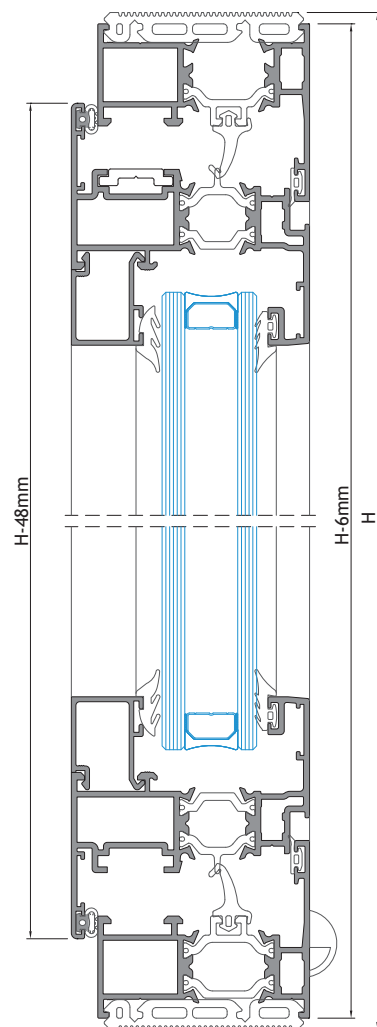

1

2

3

ESC: 1/2

PORTA DE 1 FOLHA - ABERTURA PARA INTERIOR

1 LEAF DOOR - INWARD OPENING

PORTE À 1 VANTAIL - OUVERTURE VERS L'INTÉRIEUR

PERFIS PROFILES PROFILS				
REFERÊNCIA REFERENCE RÉFÉRENCE	CORTE HORIZONTAL HORIZONTAL DETAIL DÉTAIL HORIZONTAL	CORTE VERTICAL VERTICAL DETAIL DÉTAIL VERTICALE	QUANTIDADE QUANTITY QUANTITÉ	CORTE CUT COUPÉ
IT-07	L-6	H-3	1+2	
IT-11	L-84	H-56	2+2	
IT-49	L-86	-	1	
IT-32	L-151	-	1	
-	L-208	H-220	2+2	

ACESSÓRIOS ACCESSORIES ACCESSOIRES		
CÓDIGO CODE	DESIGNAÇÃO DESIGNATION DÉSIGNATION	QUANTIDADE QUANTITY QUANTITÉ
213246	CANTO CR S/SB ANGLE COIN	4
204139	ESQUADRO IT/ST Nº3 16-1931-C BLOCKING BRACKET ÉQUERRE	2
204143	ESQUADRO IT/ST Nº6 18-2530-140 BLOCKING BRACKET ÉQUERRE	4
213309	CANTO CR 0182 ANGLE COIN	2
204151	ESQUADRO 18-0525-C BLOCKING BRACKET ÉQUERRE	4
202010	DOBRADIÇA MECANICA 1145/60 HINGE PAUMELLE	2
223100	KIT FIXAÇÃO 1145.705 FIXATION KIT KIT FIXATION	2
218170	CALÇO 1145.703/7 SHIM CALE	2
201033	FECHADURA 7797x30 LOCKER SERRURE	1
207403	SEGREDO 60/30 CYLINDER LOCK CYLINDRE DE SERRURE	1
220008	ESPELHO P/SEGREDO 5100 CYLINDER BACK PLATE COUVERCLE DE CYLINDRE	1
200747	PUXADOR DUPLO 874.3 HANDLE POIGNÉE	1
227301	QUADRA AÇO 8X140 STEEL SQUARE SHAFT BARRE SECTION CARRÉE	1
280220	TESTA FECHADURA PRUMO 2000 STRICKING PLATE GÂCHE	1
212346	CONJUNTO TAPA-TOPOS SA32 END-CAP KIT KIT DE EMBOUTE	1
218194	CALÇOS P/VIDRO EURO2000 GLAZING SHIM CALE P/VITRAGE	4

VEDANTES SEALANTS JOINTS		
CÓDIGO CODE	DESIGNAÇÃO DESIGNATION DÉSIGNATION	QUANTIDADE QUANTITY QUANTITÉ
208145	VD 2079	L+2H
208008	VD 2051 (1)	2L+2H
208184	VD 2412 (opcional optional optionnel)	L+2H
208186	VD 2105 (2)	L+2H
208350	VD 2003	2L+2H
VARIÁVEL VARIABLE	JUNTA INTERIOR GLAZING WEDGE GASKET JOINT INTÉRIEUR	2L+2H
213290	CANTO VULCANIZADO 2105.1 CORNER JOINT JOINT VULCANISÉ	2
208294	VR 3180	2L
208246	VD 1140	L

(1) 208143 VD 2071 (alternativa ao VD 2051 | alternative | alternative)
(2) 208144 VD 2305 (alternativa ao VD 2105 | alternative | alternative)

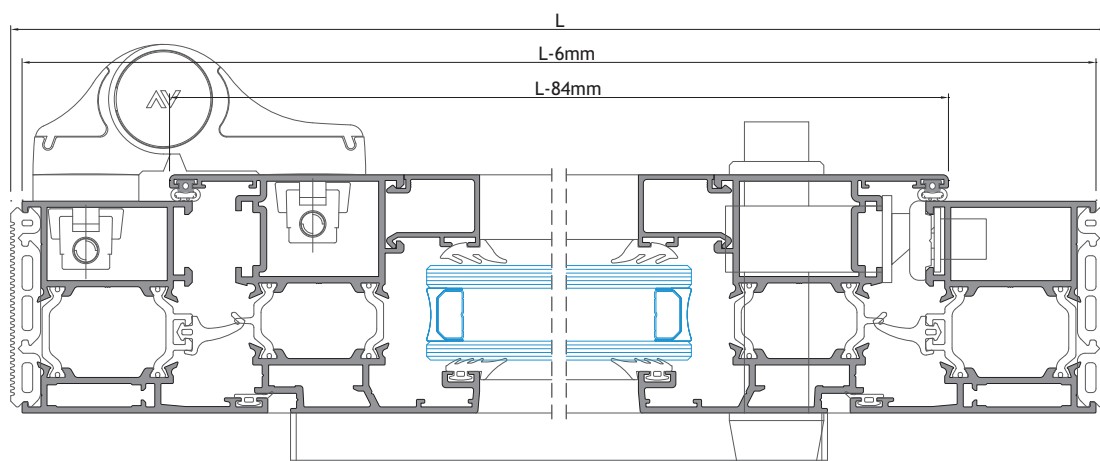
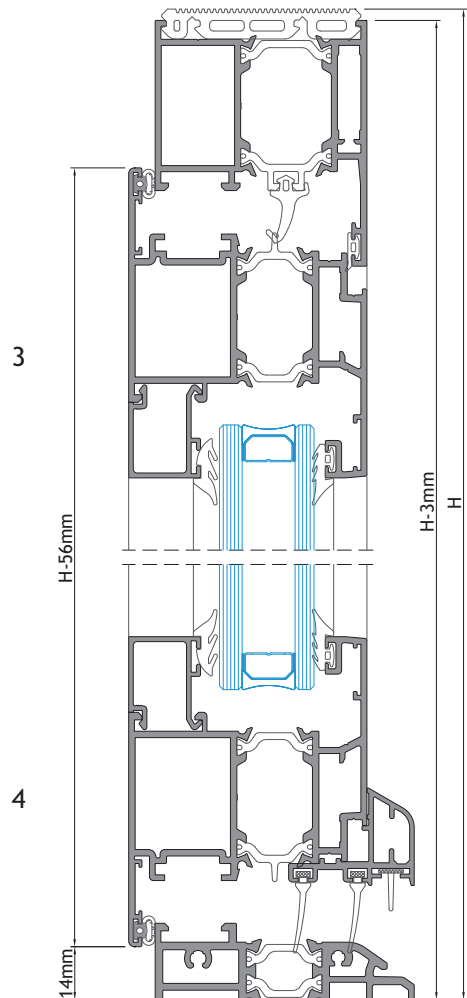
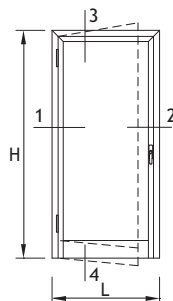

PORTA DE 2 FOLHAS - ABERTURA PARA INTERIOR

2 LEAVES DOOR - INWARD OPENING

PORTE 2 VANTAUX - OUVERTURE VERS L'INTÉRIEUR

PERFIS PROFILES PROFILS				
REFERÊNCIA REFERENCE REFERENCE	CORTE HORIZONTAL HORIZONTAL DETAIL DETAIL HORIZONTAL	CORTE VERTICAL VERTICAL DETAIL DETAIL VERTICALE	QUANTIDADE QUANTITY QUANTITÉ	CORTE CUT COUPÉ
IT-07	L-6	H-3	1+2	
IT-11	(L-91)/2	H-49	2+4	
IT-06	-	H-83	1	
IT-14	(L-314)/2	-	2	
SA-31	(L-291)/2	-	2	
SA-32	[(L-220)/2+65] (L-220)/2	-	1+1	
-	(L-339)/2	H-281	4+4	
AT-59	(L-339)/2	-	2	

ACESSÓRIOS ACCESSORIES ACCESSOIRES		
CÓDIGO CODE	DESIGNAÇÃO DESIGNATION DÉSIGNATION	QUANTIDADE QUANTITY QUANTITÉ
213246	CANTO CR 5/SB ANGLE COIN	4
204139	ESQUADRO IT/ST Nº3 16-1931-C BLOCKING BRACKET ÉQUERRE	2
204143	ESQUADRO IT/ST Nº6 18-2530-140 BLOCKING BRACKET ÉQUERRE	4
213309	CANTO CR 0182 ANGLE COIN	2
204151	ESQUADRO 18-0525-C BLOCKING BRACKET ÉQUERRE	4
202010	DOBRADEIRA MECÂNICA 1145/60 HINGE PAUMELLE	4
223100	KIT FIXAÇÃO 1145.705 FIXATION KIT KIT FIXATION	4
218170	CALÇO 1145.703/7 SHIM CALE	4
201033	FECHADURA 7797x30 LOCKER SERRURE	1
207403	SEGREDO 60/30 CYLINDER LOCK CYLINDRE DE SERRURE	1
220008	ESPELHO P/SEGREDO 5100 CYLINDER BACK PLATE COUVERCLE DE CYLINDRE	1
200747	PUXADOR DUPLO 874.3 HANDLE POIGNÉE	1
227301	QUADRA AÇO 8X140 STEEL SQUARE SHAFT BARRE SECTION CARRÉE	1
280220	TESTA FECHADURA PRUMO 2000 STRICKING PLATE GÂCHE	1
212346	CONJUNTO TAPA-TOPOS SA32 END-CAP KIT KIT DE EMBOUTE	2
218194	CALÇOS P/VIDRO EURO2000 GLAZING SHIM CALE P/VITRAGE	8
212063	CONJ. TOPO INVERSOR IT END-CAP KIT EMBOUTS	1
225155	PASSADOR REVERSÍVEL 1550 2ND LEAF LOCKER FERMETURE POUR 2ÈME VANTAUX	2
221154	HASTE-FECHO 1550.801 EXTENSION ROD HAMPE D'EXTENSION	1
202077	CONTRA-FECHO 1404 COUNTER-LOCK CONTRE-FERMETURE	2
211103	PONTO-FECHO PAVIMENTO 1409/8 FLOOR KEEPER POINT DE CLÔTURE	1

VEDANTES SEALANTS JOINTS		
CÓDIGO CODE	DESIGNAÇÃO DESIGNATION DÉSIGNATION	QUANTIDADE QUANTITY QUANTITÉ
208145	VD 2079	L+2H
208008	VD 2051 (1)	2L+3H
208184	VD 2412 (opcional optional optionnel)	L+3H
208186	VD 2105 (2)	2L+3H
208350	VD 2003	2L+4H
VARIÁVEL VARIABLE	JUNTA INTERIOR GLAZING WEDGE GASKET JOINT INTÉRIEUR	2L+4H
213290	CANTO VULCANIZADO 2105.1 CORNER JOINT JOINT VULCANISÉ	2
208464	PELÚCIA 8.5x12 STOP-FIN PLUSH JOINT BROSSE	2L

(1) 208143 VD 2071 (alternativa ao VD 2051 | alternative | alternative)
(2) 208144 VD 2305 (alternativa ao VD 2105 | alternative | alternative)

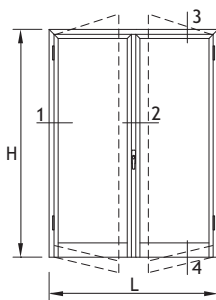

3

4

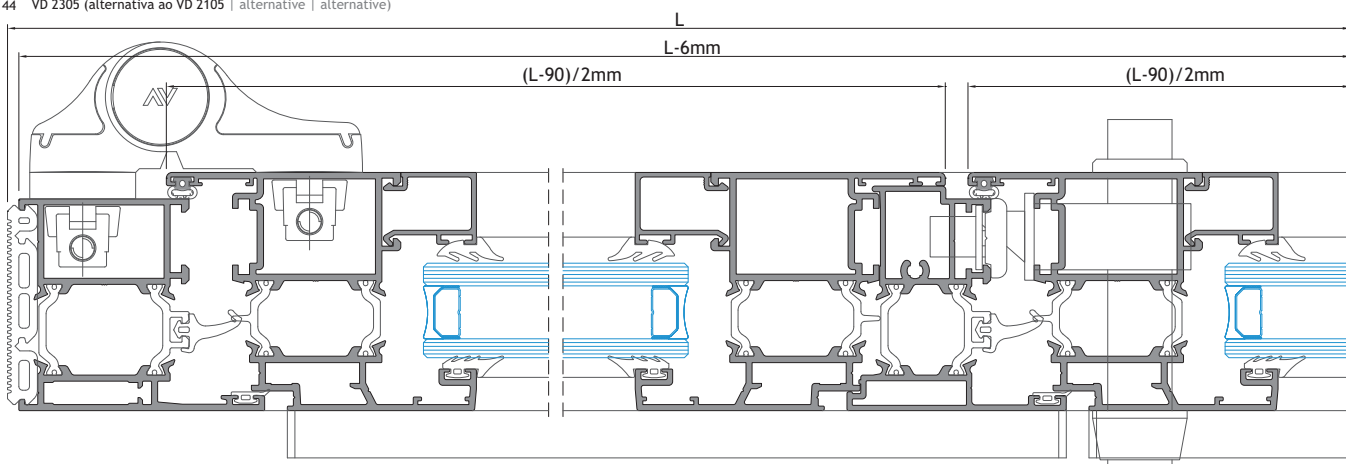
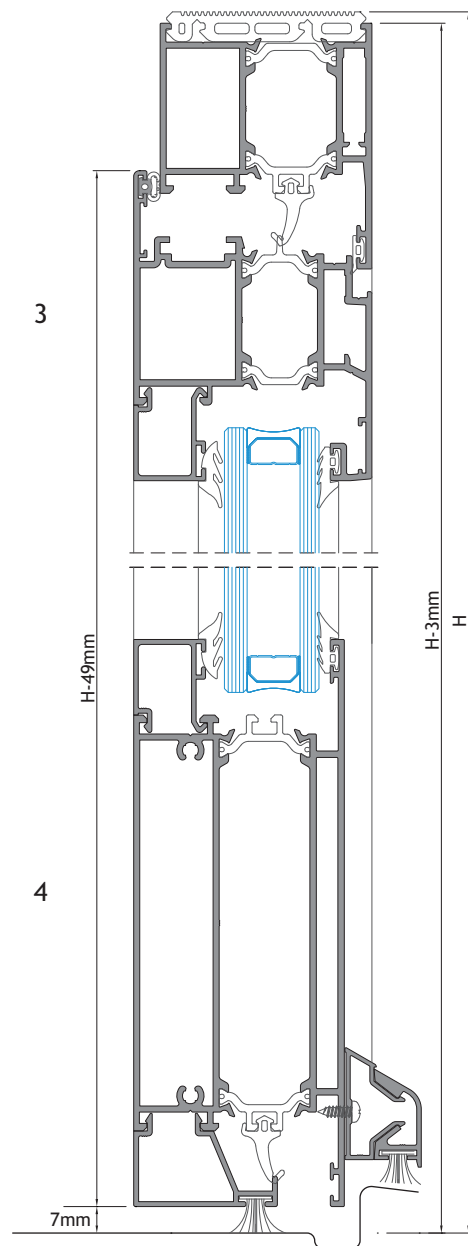

ESC: 1/2

PORTA DE 1 FOLHA - ABERTURA PARA EXTERIOR

1 LEAF DOOR - OUTWARD OPENING

PORTE 1 VANTAIL - OUVERTURE VERS L'EXTÉRIEUR

PERFIS PROFILES PROFILS				
REFERÊNCIA REFERENCE REFERENCE	CORTE HORIZONTAL HORIZONTAL DETAIL DÉTAIL HORIZONTAL	CORTE VERTICAL VERTICAL DETAIL DÉTAIL VERTICALE	QUANTIDADE QUANTITY QUANTITÉ	CORTE CUT COUPÉ
IT-07	L-6	H-3	1+2	
IT-12	L-84	H-49	2+2	
IT-14	L-217	-	1	
AT-59	L-227	-	1	
SA-31	L-267	-	1	
SA-32	L-84	-	1	
-	L-227	H-290	2+2	

ACESSÓRIOS ACCESSORIES ACCESSOIRES		
CÓDIGO CODE	DESIGNAÇÃO DESIGNATION DÉSIGNATION	QUANTIDADE QUANTITY QUANTITÉ
213246	CANTO CR S/SB ANGLE COIN	2
204139	ESQUADRO IT/ST Nº3 16-1931-C BLOCKING BRACKET ÉQUERRE	2
204730	ESQUADRO AT E. G. BLOCKING BRACKET ÉQUERRE	2
213309	CANTO CR 0182 ANGLE COIN	2
204151	ESQUADRO 18-0525-C BLOCKING BRACKET ÉQUERRE	2
202010	DOBRADIÇA MECÂNICA 1145/60 HINGE PAUMELLE	2
223100	KIT FIXAÇÃO 1145.705 FIXATION KIT KIT FIXATION	2
218170	CALÇO 1145.703/7 SHIM CALE	2
201033	FECHADURA 7797x30 LOCKER SERRURE	1
207403	SEGRED0 60/30 CYLINDER LOCK CYLINDRE DE SERRURE	1
220008	ESPELHO P/SEGRED0 5100 CYLINDER BACK PLATE COUVERCLE DE CYLINDRE	1
200747	PUXADOR DUPLO 874.3 HANDLE POIGNÉE	1
227301	QUADRA AÇO 8X140 STEEL SQUARE SHAFT BARRE SECTION CARRÉE	1
280220	TESTA FECHADURA PRUMO 2000 STRICKING PLATE GÂCHE	1
212346	CONJUNTO TAPA-TOPOS SA32 END-CAP KIT KIT DE EMBOUTE	1
218194	CALÇOS P/VIDRO EURO2000 GLAZING SHIM CALE P/VITRAGE	4
225155	PASSADOR REVERSÍVEL 1550 2ND LEAF LOCKER FERMETURE POUR 2ÈME VANTAIL	2
221154	HASTE-FECHO 1550.801 EXTENSION ROD HAMPE D'EXTENSION	1
202077	CONTRA-FECHO 1404 COUNTER-LOCK CONTRE-FERMETURE	1
211103	PONTO-FECHO PAVIMENTO 1409/8 FLOOR KEEPER POINT DE CLÔTURE	1

VEDANTES SEALANTS JOINTS		
CÓDIGO CODE	DESIGNAÇÃO DESIGNATION DÉSIGNATION	QUANTIDADE QUANTITY QUANTITÉ
208145	VD 2079	L+2H
208008	VD 2051 (1)	L+2H
208184	VD 2412 (opcional optional optionnel)	L+2H
208186	VD 2105 (2)	2L+2H
208350	VD 2003	2L+2H
VARIÁVEL VARIABLE	JUNTA INTERIOR GLAZING WEDGE GASKET JOINT INTÉRIEUR	2L+2H
213290	CANTO VULCANIZADO 2105.1 CORNER JOINT JOINT VULCANISÉ	2
208464	PELÚCIA 8.5x12 STOP-FIN PLUSH JOINT BROUSSE	2L

(1) 208143 VD 2071 (alternativa ao VD 2051 | alternative | alternative)
(2) 208144 VD 2305 (alternativa ao VD 2105 | alternative | alternative)

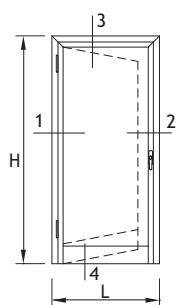

3

4

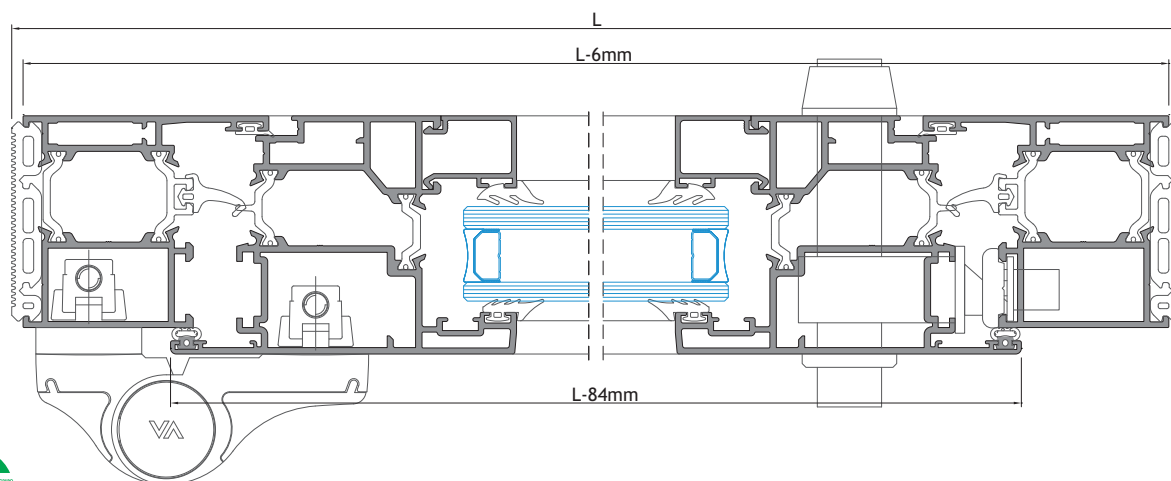
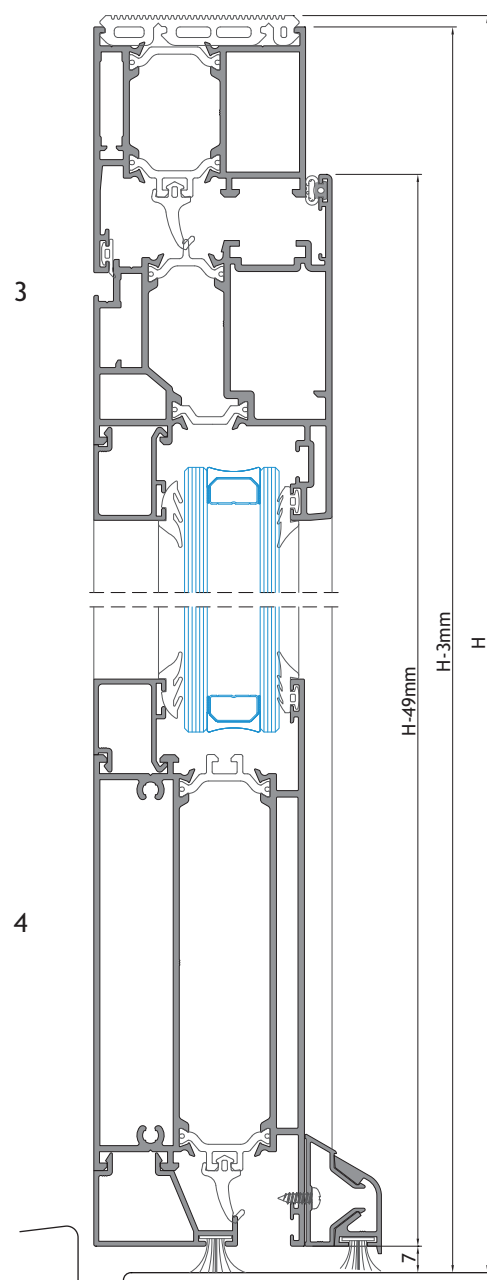

1

2

ESC: 1/2

LINHA RENOVATIO

LINE RENOVATIO

LIGNE RENOVATIO

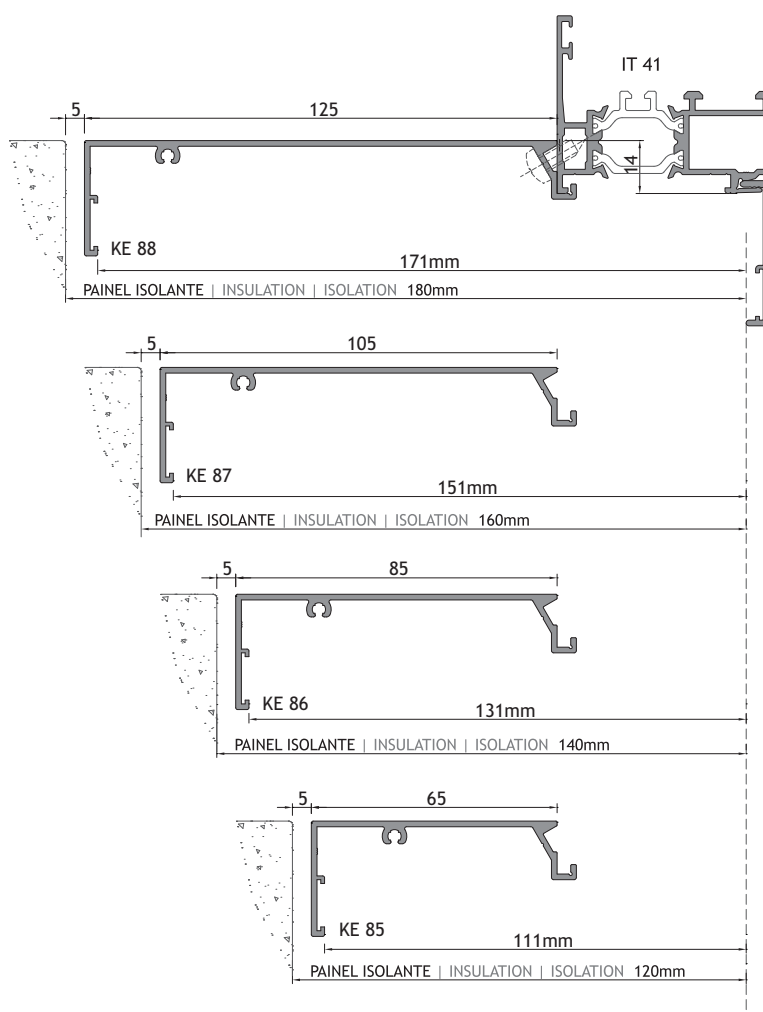
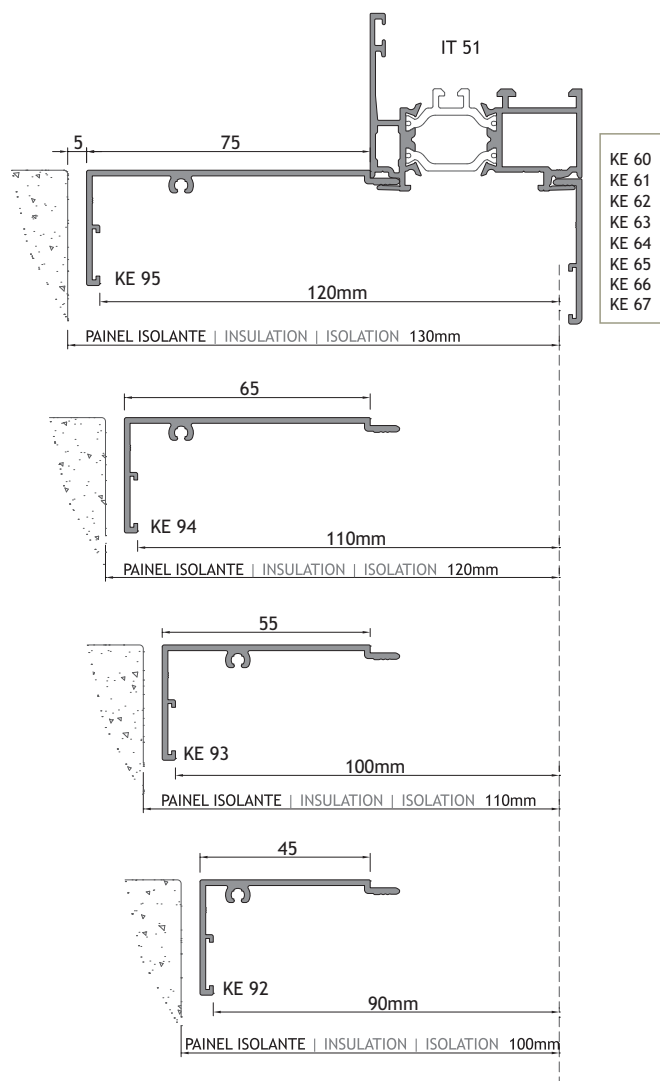

LINHA *RENOVATIO* - PAINEL DE 120mm

LINE *RENOVATIO* - 120mm PANEL

LIGNE *RENOVATION* - PANNEAU DE 120mm

Peso máximo de vidro permitido: 35Kg/m²

Maximum glass weight allowed: 35Kg/m²

Poids maximum de verre autorisé: 35Kg/m²

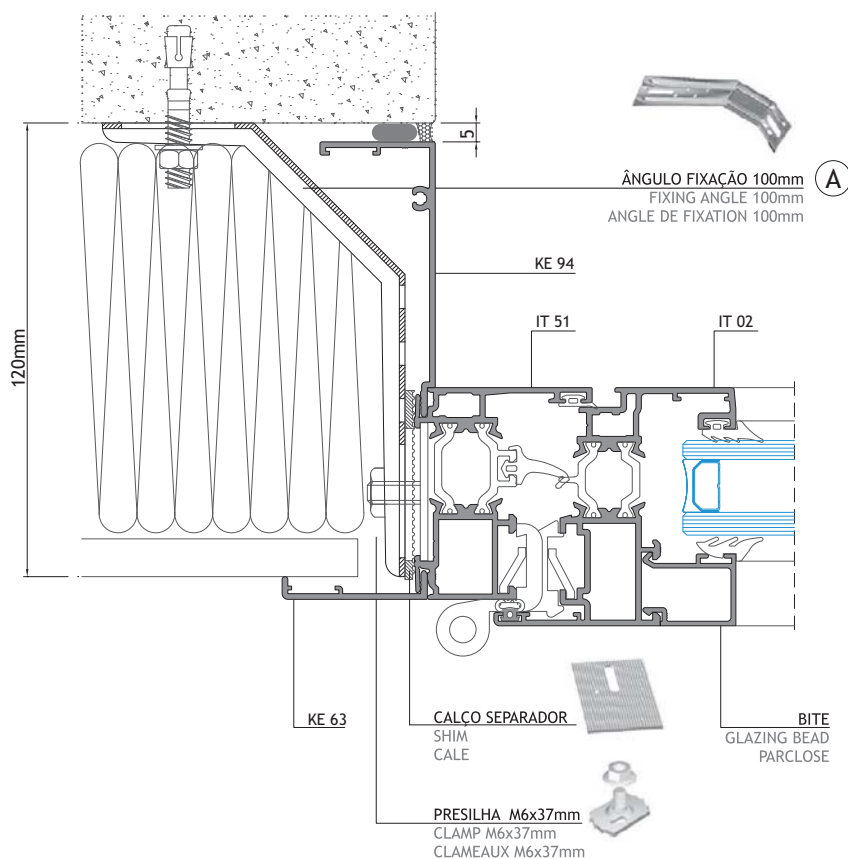
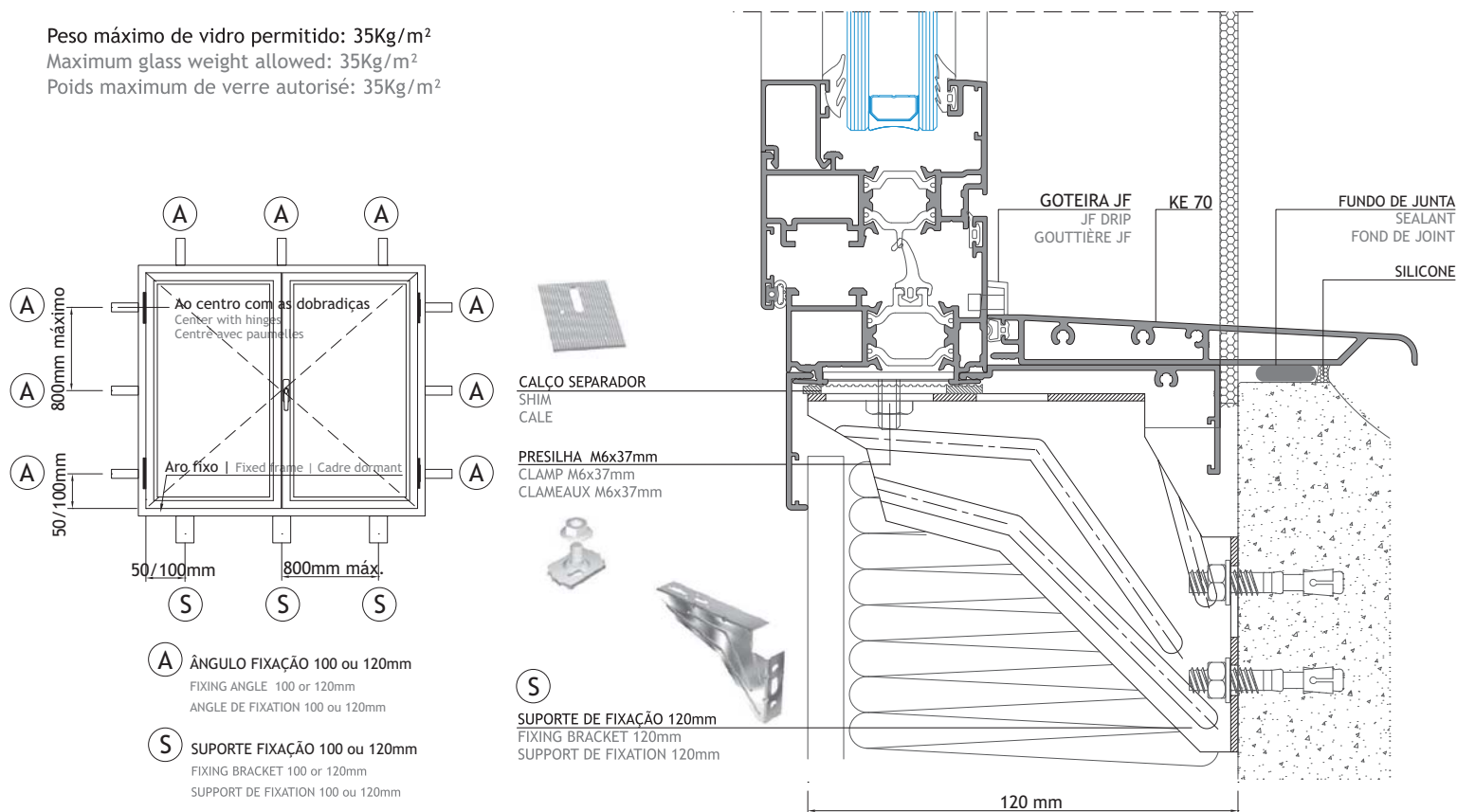







SISTEMAS
EURO 2000®
PERFIS DE ALUMÍNIO E VIDROS PARA ARQUITECTURA

ALFA SUL

EN Lisboa-Sintra Km 14
2725-397 Mem Martins
T +351 219 265 090 | F +351 219 265 098
E alfa.sul@sosoares.pt

ALULIDER

Pavilhão Industrial H - Plataforma 13D
Zona Franca Industrial
9200-047 Caniçal - Madeira
T +351 291 960 494 | F +351 291 960 497
E alulider@sosoares.pt

METALFER

Travessa do Bolegão, 146
Apartado 1
3754-904 Fermentelos
T +351 234 729 740 | F +351 234 729 741
E metalfer@sosoares.pt

PERFIS OEIRAS

Rua da Colónia - Quinta da Cardoso
Apartado 214 - Abrunheira
2711-952 Sintra
T +351 219 156 660 | F +351 219 156 661
E perfis.oeiras@sosoares.pt

PORTALEX

Estrada de S. Marcos, 23
2735-521 Cacém
T +351 210 412 500 | F +351 210 412 507
E comercial@portalex.eu

SOSOARES

Rua do Campo Alegre, 474
4150-170 Porto
T +351 226 096 709 | F +351 226 005 642
E comercial@sosoares.pt



www.sosoares.pt



www.portalex.eu